



510

IT EN DE FR ES PT

RR510 .. **i**



| | i 1/... | T ₂ [Nm] | | | | | | n _{1max} [min ⁻¹] | T _{2max} [Nm] | P _t [kW] | |
|---------------|----------------|-----------------------------|-----------------------------------|---------------------------------|------------------------------|----------------------------------|-------------------------------|---|---------------------------|------------------------|-------------------|
| | | n ₂ x h | | | | | | | | | |
| | | 10000 (10 ⁴) | 25000 (2.5 · 10 ⁴) | 50000 (5 · 10 ⁴) | 100000 (10 ⁵) | 500000 (5 · 10 ⁵) | 1000000 (10 ⁶) | | | | |
| RR510 | 3.40 | 5750 | 5430 | 5290 | 5160 | 4200 | 3410 | 3500 | 7000 (M.../FS) | 20.8 (M...) | |
| | 4.00 | 6440 | 5960 | 5360 | 4760 | 4310 | 3810 | | | 27.9 (S...) | |
| | 5.00 | 5350 | 4500 | 3960 | 3640 | 3290 | 3160 | | 32.7 (UC) | | |
| | 5.80 | 4710 | 3960 | 3480 | 3280 | 2970 | 2840 | | | | |
| | 7.00 | 3650 | 3070 | 2720 | 2600 | 2360 | 2260 | | | 14.6 (FS) | |
| RR510D | 13.60 | 5750 | 5430 | 5290 | 5160 | 4200 | 3410 | 3500 | 7000 (M.../FS) | 13 (M...) | |
| | 16.00 | 6440 | 5960 | 5360 | 4760 | 4310 | 3810 | | | 16.5 (S...) | |
| | 20.00 | 6440 | 5960 | 5360 | 4760 | 4310 | 3810 | | | 19 (UC) | |
| | 23.20 | 6440 | 5960 | 5360 | 4760 | 4310 | 3810 | | | | |
| | 29.00 | 5350 | 4500 | 3960 | 3640 | 3290 | 3160 | | | | |
| | 35.00 | 5350 | 4500 | 3960 | 3640 | 3290 | 3160 | | | | |
| | 40.60 | 4710 | 3960 | 3480 | 3280 | 2970 | 2840 | | | | |
| | 49.00 | 3650 | 3070 | 2720 | 2600 | 2360 | 2260 | | 9.8 (FS) | | |
| | RR510T | 65.60 | 6440 | 5960 | 5360 | 4760 | 4310 | | 3810 | 3500 | 7000 (M.../FS) |
| 82.00 | | 6440 | 5960 | 5360 | 4760 | 4310 | 3810 | 12.3 (S...) | | | |
| 95.12 | | 6440 | 5960 | 5360 | 4760 | 4310 | 3810 | 13.9 (UC) | | | |
| 115.2 | | 6440 | 5960 | 5360 | 4760 | 4310 | 3810 | | | | |
| 144.00 | | 6440 | 5960 | 5360 | 4760 | 4310 | 3810 | | | | |
| 167.04 | | 6440 | 5960 | 5360 | 4760 | 4310 | 3810 | | | | |
| 208.80 | | 5350 | 4500 | 3960 | 3640 | 3290 | 3160 | | | | |
| 252.00 | | 5350 | 4500 | 3960 | 3640 | 3290 | 3160 | | | | |
| 292.32 | | 4710 | 3960 | 3480 | 3280 | 2970 | 2840 | 7.8 (FS) | | | |
| 352.80 | | 3650 | 3070 | 2720 | 2600 | 2360 | 2260 | | | | |
| RR510Q | | 381.30 | 6440 | 5960 | 5360 | 4760 | 4310 | | 3810 | | 3500 |
| | 442.31 | 6440 | 5960 | 5360 | 4760 | 4310 | 3810 | | 9.7 (S...) | | |
| | 509.22 | 6440 | 5960 | 5360 | 4760 | 4310 | 3810 | | 10.9 (UC) | | |
| | 584.71 | 6440 | 5960 | 5360 | 4760 | 4310 | 3810 | | | | |
| | 669.60 | 6440 | 5960 | 5360 | 4760 | 4310 | 3810 | | | | |
| | 715.39 | 6440 | 5960 | 5360 | 4760 | 4310 | 3810 | | | | |
| | 776.74 | 6440 | 5960 | 5360 | 4760 | 4310 | 3810 | | | | |
| | 894.24 | 6440 | 5960 | 5360 | 4760 | 4310 | 3810 | | | | |
| | 1037.32 | 6440 | 5960 | 5360 | 4760 | 4310 | 3810 | | | | |
| | 1296.65 | 5350 | 4500 | 3960 | 3640 | 3290 | 3160 | | | | |
| | 1564.92 | 5350 | 4500 | 3960 | 3640 | 3290 | 3160 | | | | |
| | 1815.31 | 4710 | 3960 | 3480 | 3280 | 2970 | 2840 | 6.2 (FS) | | | |
| | 2190.89 | 3650 | 3070 | 2720 | 2600 | 2360 | 2260 | | | | |



RA510 .. **i**



| i | T ₂ [Nm] | | | | | | n _{1max} [min ⁻¹] | T _{2max} [Nm] | P _t [kW] | |
|---------------|-----------------------------|-----------------------------------|---------------------------------|------------------------------|----------------------------------|-------------------------------|---|---------------------------|------------------------|----------------------------|
| | n ₂ x h | | | | | | | | | |
| 1/... | 10000 (10 ⁴) | 25000 (2.5 · 10 ⁴) | 50000 (5 · 10 ⁴) | 100000 (10 ⁵) | 500000 (5 · 10 ⁵) | 1000000 (10 ⁶) | | | | |
| RA510 | 13.60 | 5690 | 5300 | 4680 | 4360 | 3450 | 2800 | 3500 | 7000 (M.../FS) | 23.1 (M...) 26.9 (S...) |
| | 16.00 | 6440 | 5960 | 5340 | 4760 | 3870 | 3140 | | | |
| | 20.00 | 5350 | 4500 | 3960 | 3640 | 3290 | 3160 | | | |
| | 23.20 | 4710 | 3960 | 3480 | 3280 | 2970 | 2840 | | | |
| | 28.00 | 3650 | 3070 | 2720 | 2600 | 2360 | 2260 | | 7500 (S...) | 29.2 (UC) 20 (FS) |
| RA510D | 43.79 | 5750 | 5250 | 4990 | 4750 | 3250 | 2640 | 3500 | 7000 (M.../FS) | 13.7 (M...) 16.2 (S...) |
| | 51.52 | 6440 | 5960 | 5360 | 4760 | 3640 | 2960 | | | |
| | 64.40 | 6440 | 5960 | 5360 | 4760 | 4260 | 3460 | | | |
| | 74.70 | 6440 | 5960 | 5360 | 4760 | 4310 | 3810 | | | |
| | 93.38 | 5350 | 4500 | 3960 | 3640 | 3290 | 3160 | | | |
| | 112.70 | 5350 | 4500 | 3960 | 3640 | 3290 | 3160 | | | |
| | 130.73 | 4710 | 3960 | 3480 | 3280 | 2970 | 2840 | | | |
| | 157.78 | 3650 | 3070 | 2720 | 2600 | 2360 | 2260 | | | |
| | 164.86 | 4210 | 3900 | 3690 | 3490 | 3060 | 2890 | | | |
| | 170.75 | 4340 | 4030 | 3810 | 3600 | 3160 | 2990 | | | |
| | 198.07 | 4710 | 3960 | 3480 | 3280 | 2970 | 2840 | | | |
| | 206.08 | 5160 | 4500 | 3960 | 3640 | 3290 | 3160 | | | |
| | 239.05 | 4710 | 3960 | 3480 | 3280 | 2970 | 2840 | | | |
| | 288.51 | 3650 | 3070 | 2720 | 2600 | 2360 | 2260 | | 7500 (S...) | 17.7 (UC) 11.6 (FS) |
| RA510T | 211.23 | 6440 | 5960 | 5360 | 4760 | 4310 | 3810 | 3500 | 7000 (M.../FS) | 10.8 (M...) 12.7 (S...) |
| | 264.04 | 6440 | 5960 | 5360 | 4760 | 4310 | 3810 | | | |
| | 306.29 | 6440 | 5960 | 5360 | 4760 | 4310 | 3810 | | | |
| | 370.94 | 6440 | 5960 | 5360 | 4760 | 4310 | 3810 | | | |
| | 463.68 | 6440 | 5960 | 5360 | 4760 | 4310 | 3810 | | | |
| | 537.87 | 6440 | 5960 | 5360 | 4760 | 4310 | 3810 | | | |
| | 672.34 | 5350 | 4500 | 3960 | 3640 | 3290 | 3160 | | | |
| | 811.44 | 5350 | 4500 | 3960 | 3640 | 3290 | 3160 | | | |
| | 941.27 | 4710 | 3960 | 3480 | 3280 | 2970 | 2840 | | | |
| | 1136.02 | 3650 | 3070 | 2720 | 2600 | 2360 | 2260 | | | |
| | 1187.02 | 6050 | 5610 | 5360 | 4760 | 4310 | 3810 | | | |
| | 1229.41 | 5350 | 4500 | 3960 | 3640 | 3290 | 3160 | | | |
| | 1483.78 | 5350 | 4500 | 3960 | 3640 | 3290 | 3160 | | | |
| | 1563.74 | 3650 | 3070 | 2720 | 2600 | 2360 | 2260 | | | |
| | 1721.18 | 4710 | 3960 | 3480 | 3280 | 2970 | 2840 | | | |
| | 2077.29 | 3650 | 3070 | 2720 | 2600 | 2360 | 2260 | | 7500 (S...) | 13.9 (UC) 9.2 (FS) |



510

IT EN DE FR ES PT

RR510 .. i ..



I

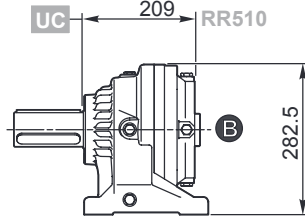
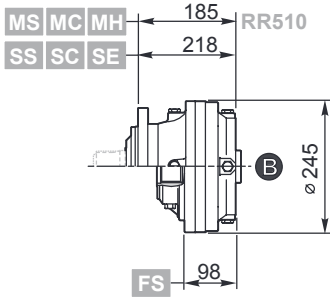

D

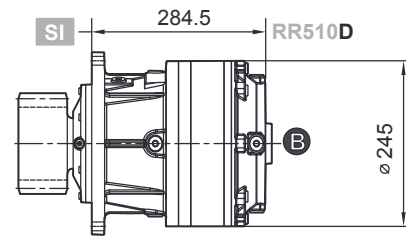
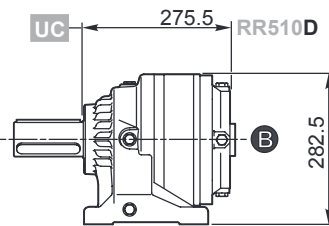
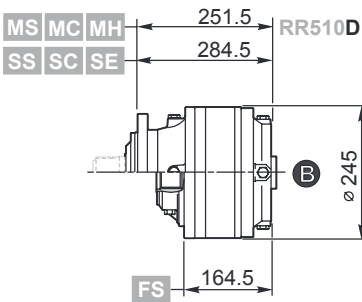

T

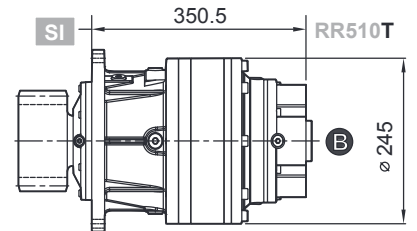
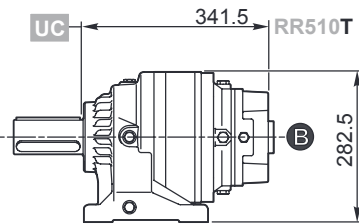
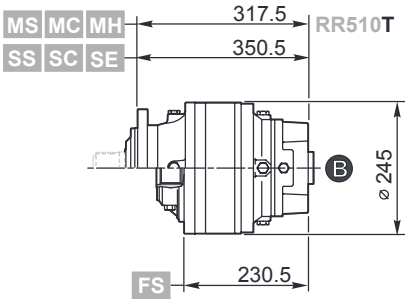

Q

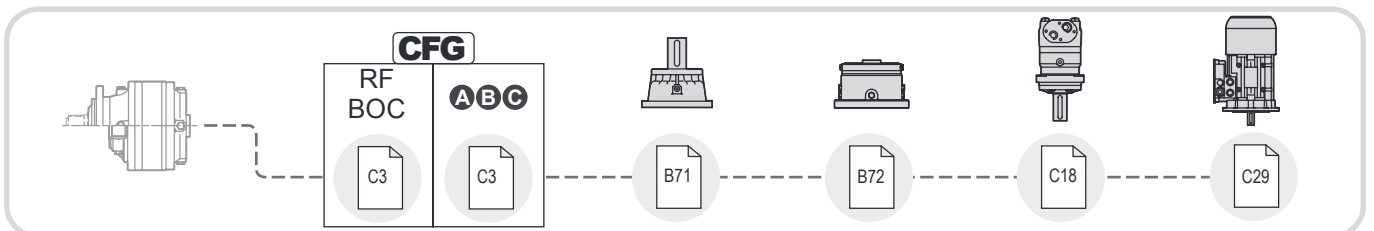
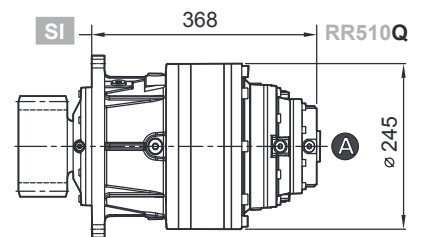
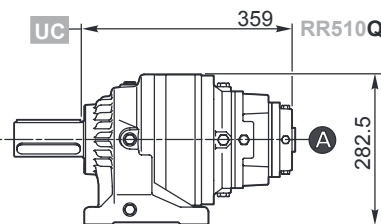
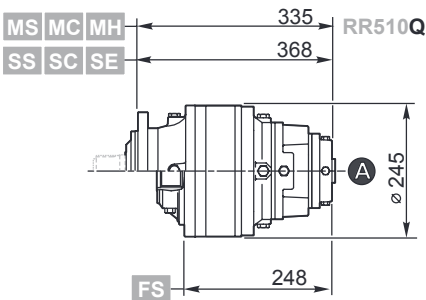



RA510 .. i ..

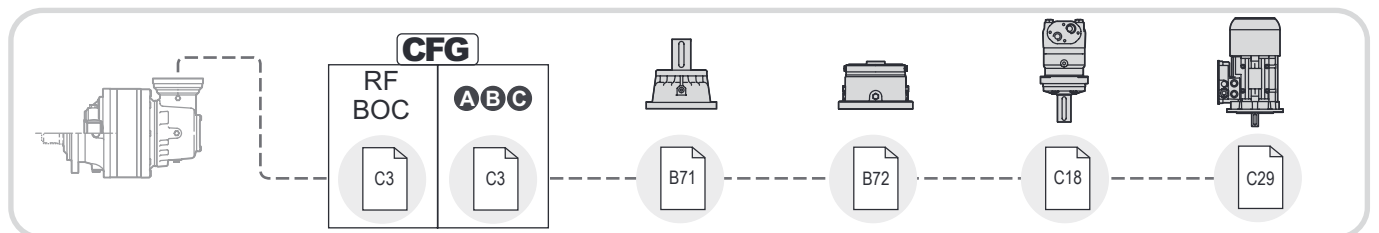
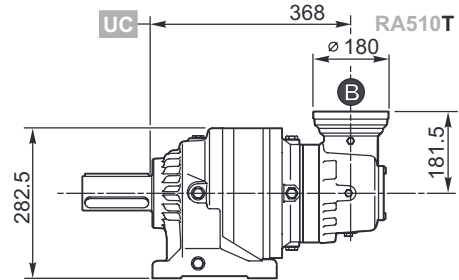
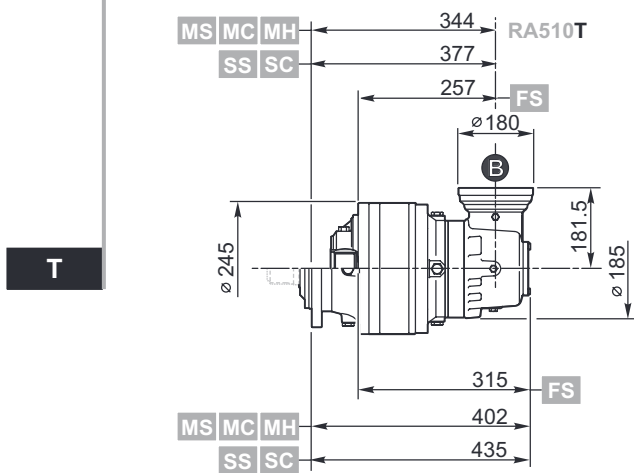
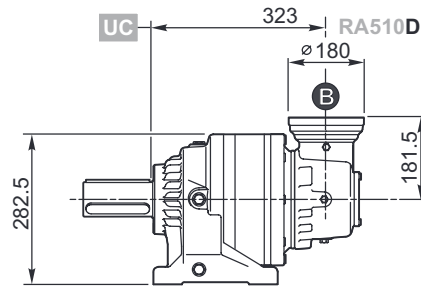
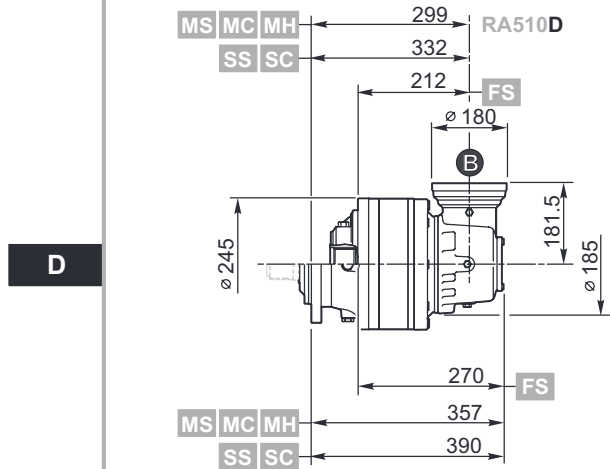
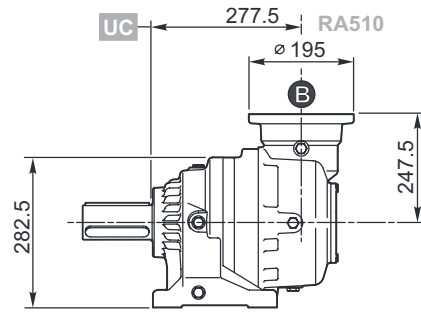
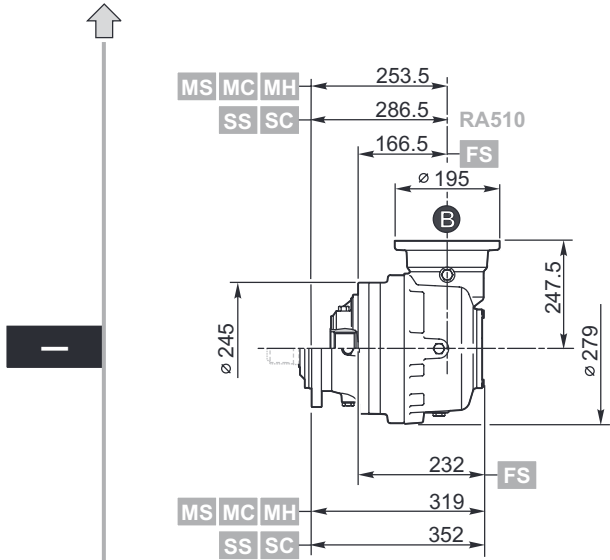

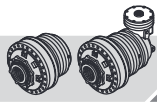







510

IT EN DEFRES PT

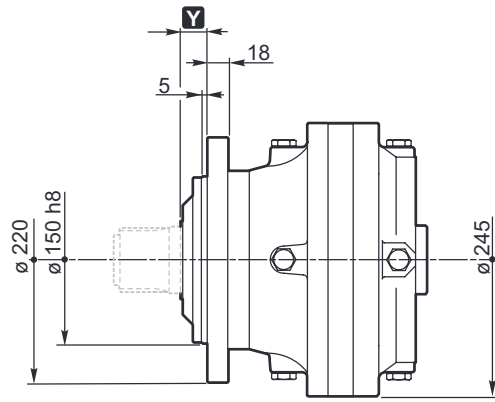
| | | | |
|-------|----|---|----|
| RR510 | .. | i | .. |
| RA510 | .. | | .. |

- MS** 
- MC** 
- MH** 



- SS** 
- SC** 
- SE** 

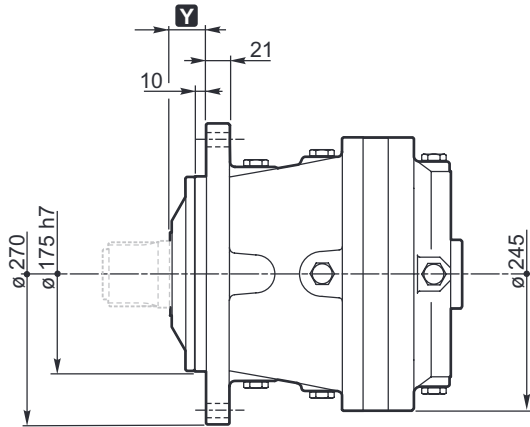

- UC** 

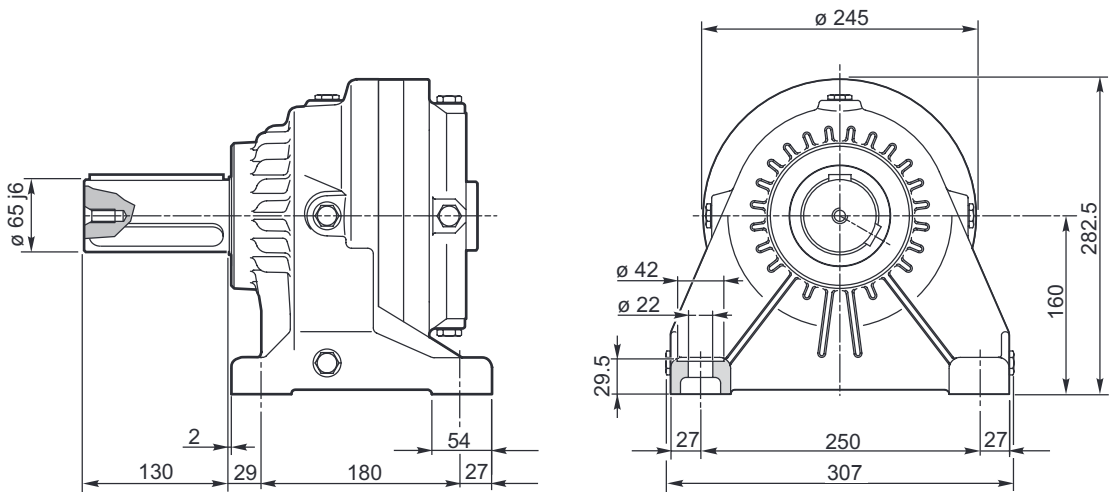

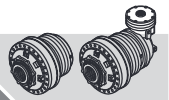

MS

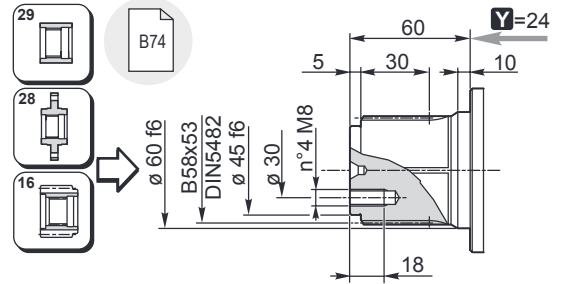
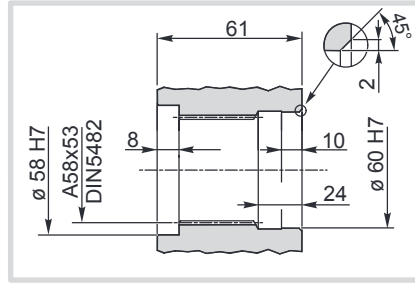
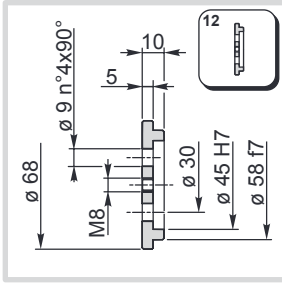

SS

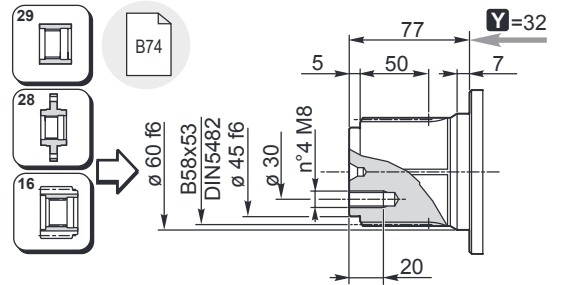
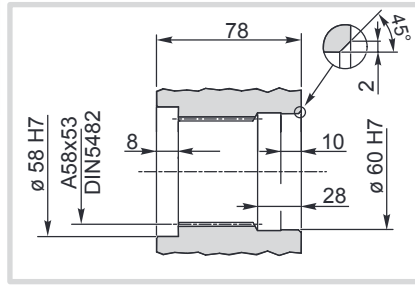

MC
SC
UC

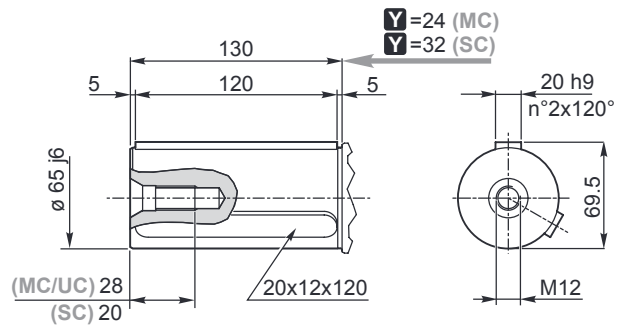
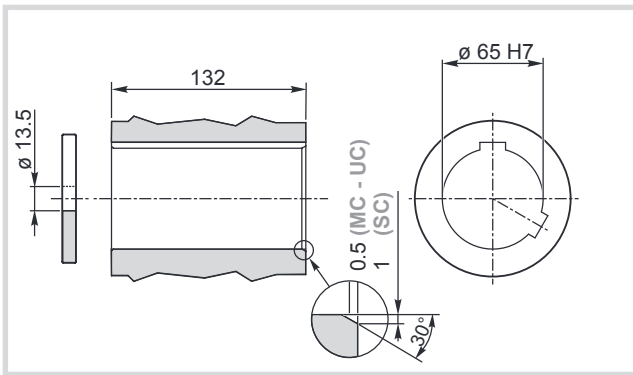

MH

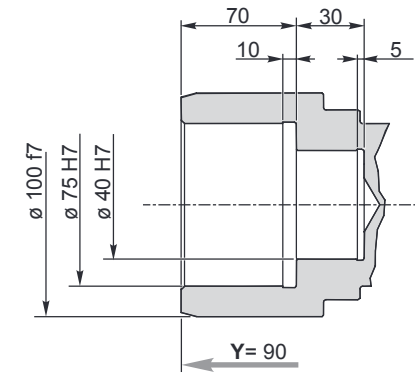
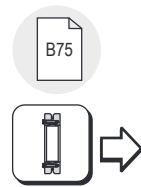
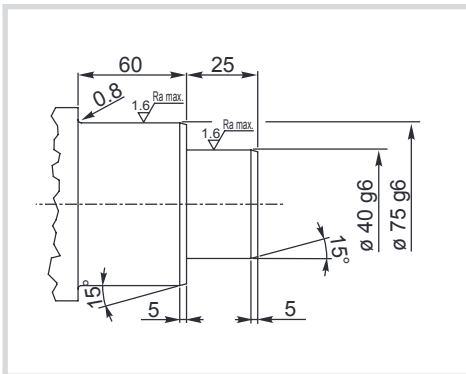

SE

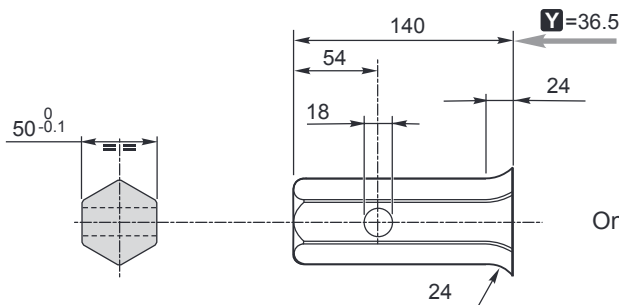

Only for RR510



510

IT EN DEFRES PT

RR510 .. i ..

SI

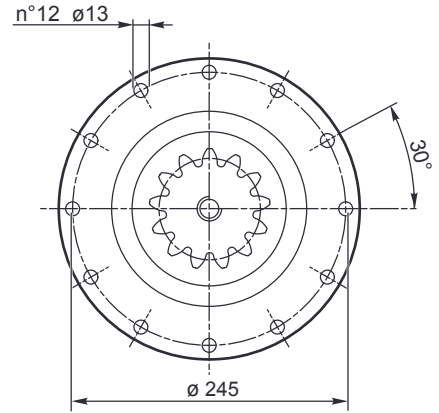
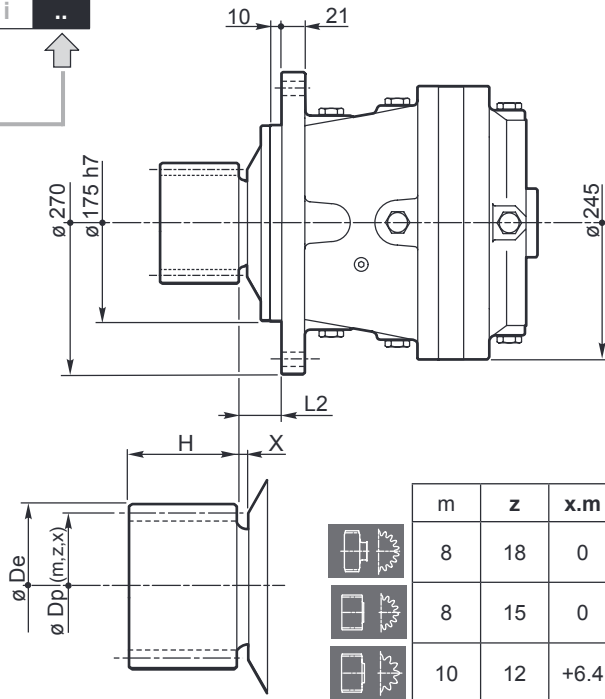

| m | z | x.m | H | Dp | De | L2 | X | code | |
|----|----|------|----|-----|-----|----|------|--------|----------|
| 8 | 18 | 0 | 60 | 144 | 160 | 59 | 28.5 | 03-325 | 154F2898 |
| 8 | 15 | 0 | 80 | 120 | 136 | 36 | 5.5 | 03-500 | 154F2899 |
| 10 | 12 | +6.4 | 80 | 120 | 149 | 40 | 9.5 | 03-579 | 154F5466 |

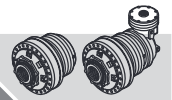

RR510
RA510 .. i **FS**

FS

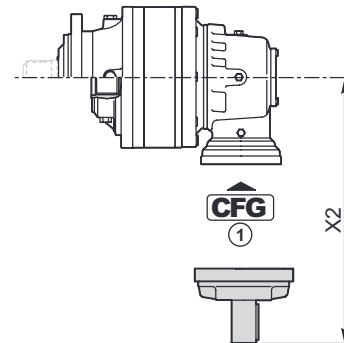
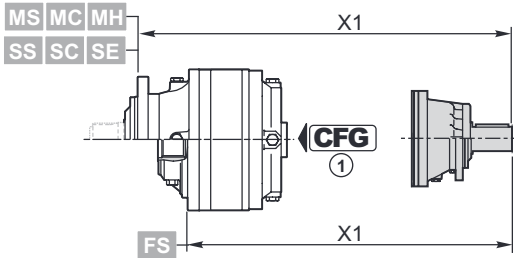
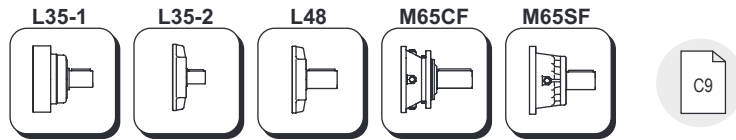
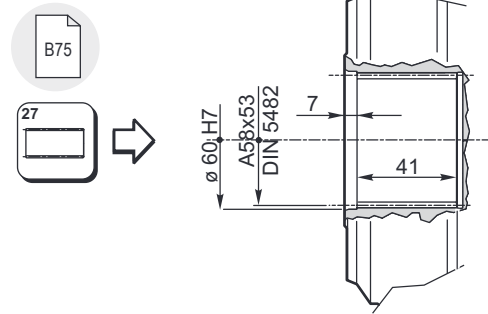
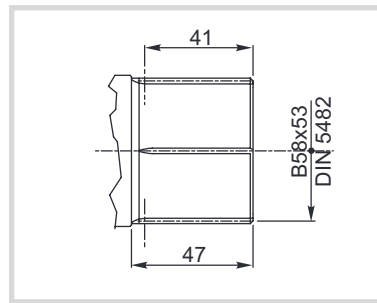
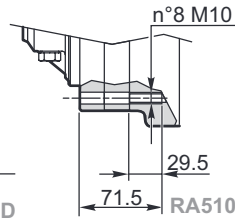
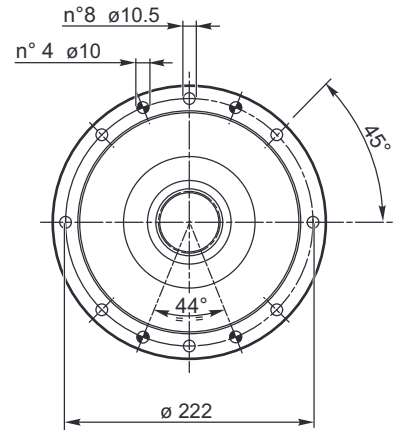
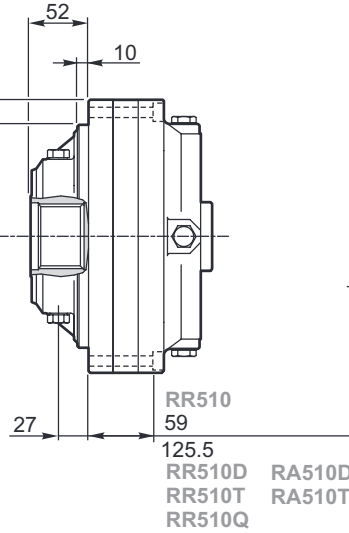

| | CFG ① | | code | X1 |
|---------------|-----------------|--------------|------------|--|
| RR510 | RF | M65SF | 154B4249 | 369.5 (M..) 282.5 (FS) 402.5 (S..) |
| | RF | M65CF | 154-2407 | 392 (M..) 305 (FS) 425 (S..) |
| | BOC | L48 | 154B3989 | 306.5 (M..) 219.5 (FS) 339.5 (S..) |
| RR510D | RF | M65SF | 154B4249 | 436 (M..) 349 (FS) 469 (S..) |
| | RF | M65CF | 154-2407 | 459 (M..) 372 (FS) 492 (S..) |
| | BOC | L48 | 154B3989 | 373 (M..) 286 (FS) 406 (S..) |
| RR510T | BOC | L35-2 | 154-2190M1 | 407 (M..) 320 (FS) 440 (S..) |
| RR510Q | RF | L35-1 | 154B4054 | 423 (M..) 336 (FS) 456 (S..) |

| | CFG ① | | code | X2 |
|---------------|-----------------|--------------|------------|-------|
| RA510 | BOC | L48 | 154B3989 | 347.5 |
| RA510D | BOC | L35-2 | 154-2190M1 | 270.5 |
| RA510T | BOC | L35-2 | 154-2190M1 | 270.5 |

CFG

RF

BOC

A

B

C

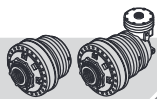

510

IT EN DE FR ES PT

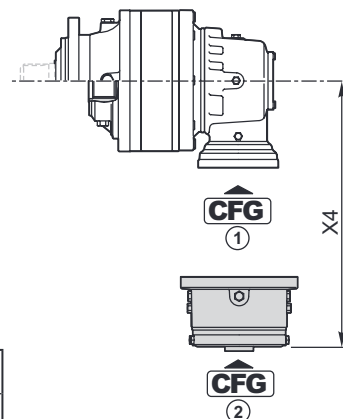
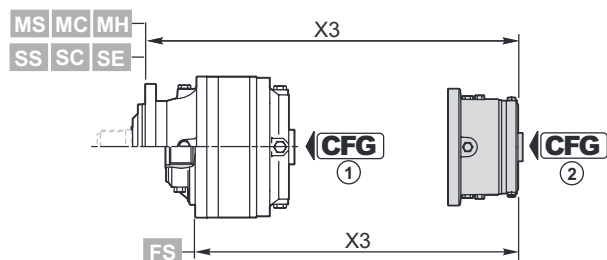
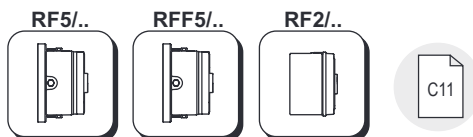

| CFG | |
|-----|----|
| RF | C3 |
| BOC | |
| A | C3 |
| B | |
| C | |

| RF5/.. | CFG ① | T _f [Nm] | CFG ② | | | | | | |
|--------|-------|---------------------|----------|--|----|----------------|----------------|--|----|
| | | | B | | | OMTS 12/24 z16 | OMVS 10/20 z16 | | |
| | | | code | X3 | X4 | code | code | X3 | X4 |
| RR510 | RF | 210 | 154-2872 | 275.5 (M...) 188.5 (FS) 308.5 (S...) | — | 154-2879 | 154-2886 | 279.2 (M...) 192.2 (FS) 312.2 (S...) | — |
| | | 290 | 154-2873 | | | 154-2880 | 154-2887 | | |
| | | 430 | 154-2874 | | | 154-2881 | 154-2888 | | |
| | | 650 | 154-2875 | | | 154-2882 | 154-2889 | | |
| | | 850 | 154-2876 | | | 154-2883 | 154-2890 | | |
| | | 1100 | 154-2877 | | | 154-2884 | 154-2891 | | |
| RR510D | RF | 210 | 154-2872 | 342 (M...) 255 (FS) 375 (S...) | — | 154-2879 | 154-2886 | 345.7 (M...) 258.7 (FS) 378.7 (S...) | — |
| | | 290 | 154-2873 | | | 154-2880 | 154-2887 | | |
| | | 430 | 154-2874 | | | 154-2881 | 154-2888 | | |
| | | 650 | 154-2875 | | | 154-2882 | 154-2889 | | |
| | | 850 | 154-2876 | | | 154-2883 | 154-2890 | | |
| | | 1100 | 154-2877 | | | 154-2884 | 154-2891 | | |
| | | 1300 | 154-2878 | | | 154-2885 | 154-2892 | | |

| RFF5/.. | CFG ① | T _f [Nm] | CFG ② | | | | | | | | | | | | |
|---------|-------|---------------------|----------|----|-------|----------------|----------------|----|-------|--|--|----------|----------|--|--|
| | | | B | | | OMTS 12/24 z16 | OMVS 10/20 z16 | | | | | | | | |
| | | | code | X3 | X4 | code | code | X3 | X4 | | | | | | |
| RA510 | RF | 210 | 154-2893 | — | 316.6 | 154-5338 | 154-5345 | — | 320.5 | | | | | | |
| | | 290 | 154-2894 | | | 154-5339 | 154-5346 | | | | | | | | |
| | | 430 | 154-2895 | | | 154-5340 | 154-5347 | | | | | | | | |
| | | 650 | 154-2896 | | | 154-5341 | 154-5348 | | | | | | | | |
| | | 850 | 154-2897 | | | 154-5342 | 154-5349 | | | | | | | | |
| | | 1100 | 154-2898 | | | 154-5343 | 154-5350 | | | | | | | | |
| | | | | | | 1300 | 154-2899 | | | | | 154-5344 | 154-5351 | | |



| RF2/.. | CFG ① | T _f [Nm] | CFG ② | | | | | | |
|--------|-------|---------------------|------------|--|-----------------------|------------------------|-----------------------|------------------------|--|
| | | | B | | OMP/OMR SAE A 2B Ø 25 | OMP/OMR SAE A 2B 1" 6B | OMP/OMR SAE A 4B Ø 25 | OMP/OMR SAE A 4B 1" 6B | X3 |
| | | | code | X3 | code | code | code | code | |
| RR510 | RF | 70 | 154B9195 | 248 (M...) 161 (FS) 281 (S...) | 154B9195M10 | — | 154B9195M16 | 154B9195M17 | 238 (M...) 151 (FS) 271 (S...) |
| | | 140 | 154B9196 | | 154B9196M10 | — | 154B9196M16 | 154B9196M17 | |
| | | 210 | 154B9197 | | 154B9197M10 | — | 154B9197M16 | 154B9197M17 | |
| | | 320 | 154B9198 | | 154B9198M10 | — | 154B9198M16 | 154B9198M17 | |
| | | 430 | 154B9199 | | 154B9199M10 | — | 154B9199M16 | 154B9199M17 | |
| | | 600 | 154B9200 | | 154B9200M10 | — | 154B9200M16 | 154B9200M17 | |
| RR510D | RF | 70 | 154-2345 | 314.5 (M...) 227.5 (FS) 347.5 (S...) | 154-2345M10 | 154-2345M11 | 154-2345M16 | 154-2345M17 | 304.5 (M...) 217.5 (FS) 337.5 (S...) |
| | | 140 | 154-2346 | | 154-2346M10 | 154-2346M11 | 154-2346M16 | 154-2346M17 | |
| | | 210 | 154-2347 | | 154-2347M10 | 154-2347M11 | 154-2347M16 | 154-2347M17 | |
| | | 320 | 154-2348 | | 154-2348M10 | 154-2348M11 | 154-2348M16 | 154-2348M17 | |
| | | 430 | 154-2349 | | 154-2349M10 | 154-2349M11 | 154-2349M16 | 154-2349M17 | |
| | | 600 | 154B9186 | | 154B9186M10 | 154B9186M11 | 154B9186M16 | 154B9186M17 | |
| RR510T | RF | 70 | 154-2838M1 | 356 (M...) 269 (FS) 389 (S...) | 154-2863 | 154-2863M11 | 154-2635 | 154-2635M11 | 346 (M...) 259 (FS) 379 (S...) |
| | | 140 | 154-2839M1 | | 154-2864 | 154-2864M11 | 154-2636 | 154-2636M11 | |
| | | 210 | 154-2840M1 | | 154-2865 | 154-2865M11 | 154-2637 | 154-2637M11 | |
| | | 320 | 154-2841M1 | | 154-2866 | 154-2866M11 | 154-2638 | 154-2638M11 | |
| | | 430 | 154-2842M1 | | 154-2867 | 154-2867M11 | 154-2639 | 154-2639M11 | |
| | | 600 | 154B8962M1 | | 154B9665 | 154B9665M11 | 154B9666 | 154B9666M11 | |

| | CFG ① | T _f [Nm] | CFG ② | | | | | | |
|--------|-------|---------------------|------------|--------------------------------------|-----------------------|------------------------|-----------------------|------------------------|--|
| | | | A | | OMP/OMR SAE A 2B Ø 25 | OMP/OMR SAE A 2B 1" 6B | OMP/OMR SAE A 4B Ø 25 | OMP/OMR SAE A 4B 1" 6B | X3 |
| | | | code | X3 | code | code | code | code | |
| RR510Q | RF | 70 | 154-2832M1 | 401 (M...) 314 (FS) 434 (S...) | 154-2858M1 | 154-2858M5 | | | 396.5 (M...) 309.5 (FS) 429.5 (S...) |
| | | 140 | 154-2833M1 | | 154-2859M1 | 154-2859M5 | | | |
| | | 210 | 154-2834M1 | | 154-2860M1 | 154-2860M5 | | | |
| | | 320 | 154-2836M1 | | 154-2861M1 | 154-2861M5 | | | |
| | | 430 | 154-2837M1 | | 154-2862M1 | 154-2862M5 | | | |
| | | 600 | 154B8959M1 | | 154B9663M1 | 154B9663M5 | | | |

| | CFG ① | T _f [Nm] | CFG ② | | | | | | |
|--------|-------|---------------------|-------------|-------|-----------------------|------------------------|-----------------------|------------------------|-------|
| | | | B | | OMP/OMR SAE A 2B Ø 25 | OMP/OMR SAE A 2B 1" 6B | OMP/OMR SAE A 4B Ø 25 | OMP/OMR SAE A 4B 1" 6B | X4 |
| | | | code | X4 | code | code | code | code | |
| RA510 | RF | 70 | 154F2991 | 285.3 | | | | | |
| | | 140 | 154F1890 | | | | | | |
| | | 210 | 154F2961 | | | | | | |
| | | 320 | 154B3591 | | | | | | |
| | | 430 | 154B3592 | | | | | | |
| | | 600 | 154F2992 | | | | | | |
| RA510D | RF | 70 | 154-2838M12 | 223.8 | 154-2863M12 | 154-2863M13 | 154-2635M12 | | 213.8 |
| | | 140 | 154-2839M12 | | 154-2864M12 | 154-2864M13 | 154-2636M12 | | |
| | | 210 | 154-2840M12 | | 154-2865M12 | 154-2865M13 | 154-2637M12 | | |
| | | 320 | 154-2841M12 | | 154-2866M12 | 154-2866M13 | 154-2638M12 | | |
| | | 430 | 154-2842M12 | | 154-2867M12 | 154-2867M13 | 154-2639M12 | | |
| | | 600 | 154B8962M12 | | 154B9665M12 | 154B9665M13 | 154B9666M12 | | |
| RA510T | RF | 70 | 154-2838M12 | 223.8 | 154-2863M12 | 154-2863M13 | 154-2635M12 | | 213.8 |
| | | 140 | 154-2839M12 | | 154-2864M12 | 154-2864M13 | 154-2636M12 | | |
| | | 210 | 154-2840M12 | | 154-2865M12 | 154-2865M13 | 154-2637M12 | | |
| | | 320 | 154-2841M12 | | 154-2866M12 | 154-2866M13 | 154-2638M12 | | |
| | | 430 | 154-2842M12 | | 154-2867M12 | 154-2867M13 | 154-2639M12 | | |
| | | 600 | 154B8962M12 | | 154B9665M12 | 154B9665M13 | 154B9666M12 | | |

CFG

RF BOC C3

A
B
C C3

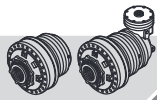

510

IT EN DEFRES PT



Kg 0.2

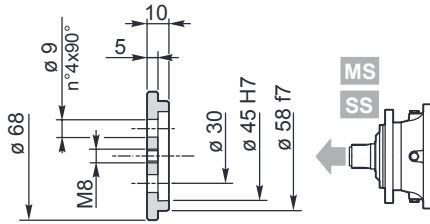

Materiale / Material / Material / Matériau / Material / Material:
 Acciaio / Steel / Stahl / Acier / Acero / Aço
 C40 EN 10083-1 (1.1186)

154-3061

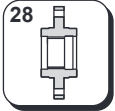

Materiale / Material / Material / Matériau / Material / Material:
 Acciaio / Steel / Stahl / Acier / Acero / Aço EN 10083-1-C40 (1.1186)

154-3086

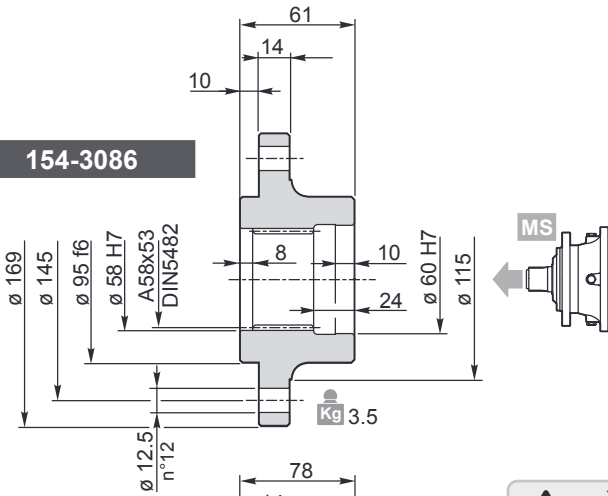

154-3087

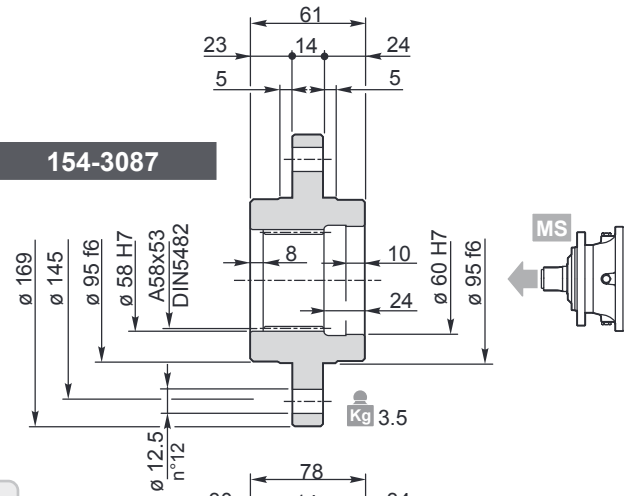

$T_{2max} = 6940 \text{ Nm}$

154-3088

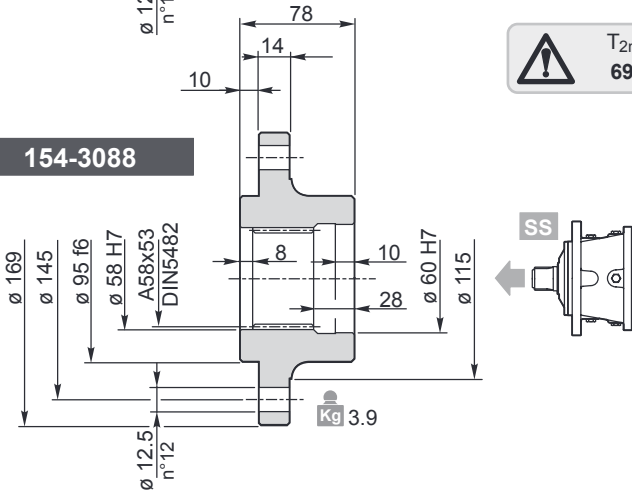

154-3089

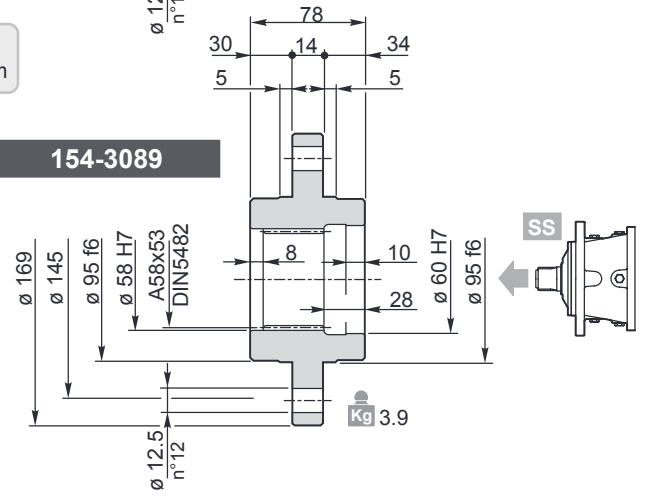

Materiale / Material / Material / Matériau / Material / Material:
 Acciaio / Steel / Stahl / Acier / Acero / Aço 39NiCrMo3 UNI 7845 (1.6511)

154-3091

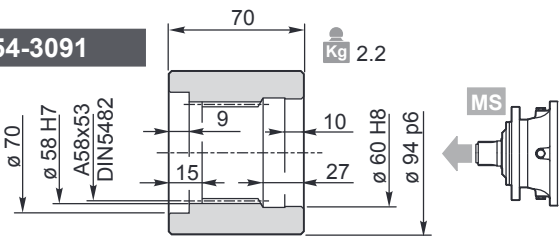

154-3092

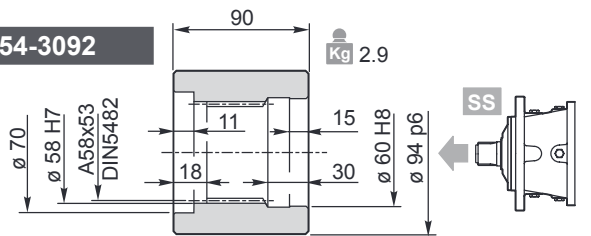

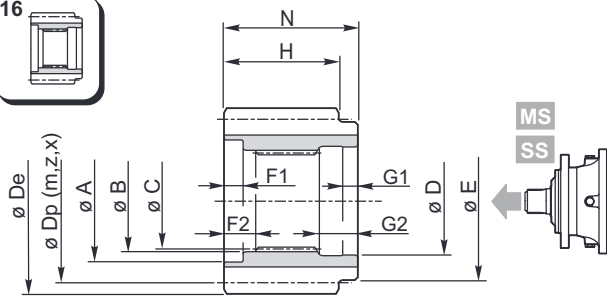
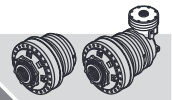

Materiale / Material / Material
 Matériau / Material / Material
 Acciaio / Steel / Stahl / Acier / Acero / Aço
 39NiCrMo3 UNI 7845 (1.6511)

| | A | B | C | D | E | F1 | F2 | G1 | G2 | N | m | z | x | H | Dp | De | Code |
|----|-------|-------------------|-------------------|-------|----|----|----|----|----|----|-----|----|--------|-----|-----|----------|----------|
| MS | 70 | 58 H7 | DIN5482 A58x53 | 60 H7 | 72 | 7 | 13 | 12 | 27 | 68 | 4.5 | 18 | 0.4444 | 65 | 81 | 93 | 154-3106 |
| | 70 | 58 H7 | DIN5482 A58x53 | 60 H7 | 68 | 7 | 13 | 10 | 27 | 68 | 5 | 17 | 0.4 | 65 | 85 | 98 | 154-2287 |
| | 70 | 58 H7 | DIN5482 A58x53 | 60 H7 | 68 | 7 | 13 | 10 | 27 | 68 | 5 | 19 | 0 | 65 | 95 | 104 | 154-2286 |
| | 70 | 58 H7 | DIN5482 A58x53 | 60 H7 | 75 | 7 | 13 | 12 | 27 | 68 | 6 | 14 | 0.5 | 65 | 84 | 101.5 | 154-3082 |
| | 70 | 58 H7 | DIN5482 A58x53 | 60 H7 | 68 | 7 | 13 | 10 | 27 | 68 | 6 | 15 | 0.25 | 65 | 90 | 103 | 154-3107 |
| | 70 | 58 H7 | DIN5482 A58x53 | 60 H7 | 68 | 7 | 13 | 10 | 27 | 68 | 6 | 16 | 0.25 | 65 | 96 | 109 | 154-3245 |
| | 70 | 58 H7 | DIN5482 A58x53 | 60 H7 | 78 | 7 | 13 | 12 | 27 | 68 | 8 | 12 | 0.5 | 65 | 96 | 118 | 154-3074 |
| | 70 | 58 H7 | DIN5482 A58x53 | 60 H7 | 68 | 7 | 13 | 10 | 27 | 68 | 8 | 14 | 0 | 65 | 112 | 126 | 154-3250 |
| | 70 | 58 H7 | DIN5482 A58x53 | 60 H7 | 78 | 7 | 13 | 12 | 27 | 68 | 8 | 15 | 0 | 65 | 120 | 136 | 154-3246 |
| | 70 | 58 H7 | DIN5482 A58x53 | 60 H7 | 68 | 7 | 13 | 10 | 27 | 68 | 8 | 15 | 0.25 | 65 | 120 | 138 | 154-3235 |
| | 70 | 58 H7 | DIN5482 A58x53 | 60 H7 | 78 | 7 | 13 | 12 | 27 | 68 | 8 | 18 | 0 | 65 | 144 | 158 | 154-3103 |
| | 70 | 58 H7 | DIN5482 A58x53 | 60 H7 | 78 | 7 | 13 | 12 | 27 | 68 | 10 | 10 | 0.25 | 65 | 100 | 124.5 | 154-3075 |
| | 70 | 58 H7 | DIN5482 A58x53 | 60 H7 | 78 | 7 | 13 | 12 | 27 | 68 | 10 | 12 | 0.475 | 65 | 120 | 149.5 | 154-3105 |
| | 70 | 58 H7 | DIN5482 A58x53 | 60 H7 | 68 | 7 | 13 | 10 | 27 | 68 | 10 | 15 | 0 | 65 | 150 | 167 | 154-3248 |
| SS | 70 | 58 H7 | DIN5482 A58x53 | 60 H7 | 78 | 5 | 12 | 12 | 30 | 84 | 6 | 14 | 0.5 | 80 | 84 | 101.5 | 154-3238 |
| | 70 | 58 H7 | DIN5482 A58x53 | 60 H7 | 78 | 5 | 12 | 12 | 30 | 84 | 6 | 16 | 0.4167 | 80 | 96 | 111 | 154-3234 |
| | 70 | 58 H7 | DIN5482 A58x53 | 60 H7 | 78 | 5 | 12 | 12 | 30 | 84 | 6 | 19 | 0 | 80 | 114 | 126 | 154-2706 |
| | 70 | 58 H7 | DIN5482 A58x53 | 60 H7 | 78 | 6 | 12 | 10 | 30 | 84 | 6 | 24 | 0 | 80 | 144 | 154 | 154-3101 |
| | 70 | 58 H7 | DIN5482 A58x53 | 60 H7 | 78 | 5 | 12 | 12 | 30 | 84 | 7 | 13 | 0.5 | 80 | 91 | 109 | 154-3038 |
| | 70 | 58 H7 | DIN5482 A58x53 | 60 H7 | 78 | 5 | 12 | 12 | 30 | 84 | 8 | 12 | 0.5 | 80 | 96 | 118 | 154-3076 |
| | 70 | 58 H7 | DIN5482 A58x53 | 60 H7 | 78 | 5 | 12 | 12 | 30 | 84 | 8 | 13 | 0.35 | 80 | 104 | 125.6 | 154-3236 |
| | 70 | 58 H7 | DIN5482 A58x53 | 60 H7 | 78 | 5 | 12 | 12 | 30 | 84 | 8 | 15 | 0.25 | 80 | 120 | 138 | 154-2288 |
| | 70 | 58 H7 | DIN5482 A58x53 | 60 H7 | 78 | 5 | 12 | 12 | 30 | 84 | 8 | 18 | 0 | 80 | 144 | 158 | 154-2716 |
| | 70 | 58 H7 | DIN5482 A58x53 | 60 H7 | 78 | 5 | 12 | 12 | 30 | 84 | 10 | 10 | 0.25 | 80 | 100 | 124.5 | 154-3067 |
| | 70 | 58 H7 | DIN5482 A58x53 | 60 H7 | 78 | 5 | 12 | 12 | 30 | 84 | 10 | 12 | 0.475 | 80 | 120 | 149.5 | 154-3077 |
| | 70 | 58 H7 | DIN5482 A58x53 | 60 H7 | 78 | 5 | 12 | 12 | 30 | 84 | 10 | 13 | 0 | 80 | 130 | 148 | 154-3070 |
| | 70 | 58 H7 | DIN5482 A58x53 | 60 H7 | 78 | 5 | 12 | 12 | 30 | 84 | 10 | 14 | 0.4 | 80 | 140 | 164 | 154-2289 |
| | 70 | 58 H7 | DIN5482 A58x53 | 60 H7 | 78 | 5 | 12 | 12 | 30 | 84 | 10 | 15 | 0 | 80 | 150 | 169 | 154-3078 |
| 70 | 58 H7 | DIN5482 A58x53 | 60 H7 | 78 | 5 | 12 | 12 | 30 | 84 | 10 | 16 | 0 | 80 | 160 | 178 | 154-3108 | |

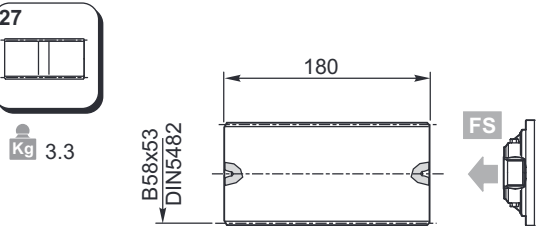
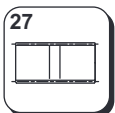

154-3052

Materiale / Materiale / Material
 Matériau / Material / Material:
 Acciaio / Steel / Stahl / Acier / Acero / Aço
 39NiCrMo3 UNI 7845 (1.6511)

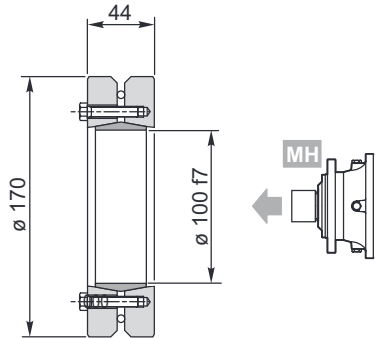
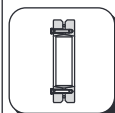

154B3090



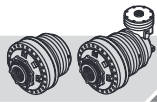

510

IT EN DE FR ES PT

| | | | |
|----|-----|----|-----------|
| RR | 510 | .. | MS |
| RA | | | MC |

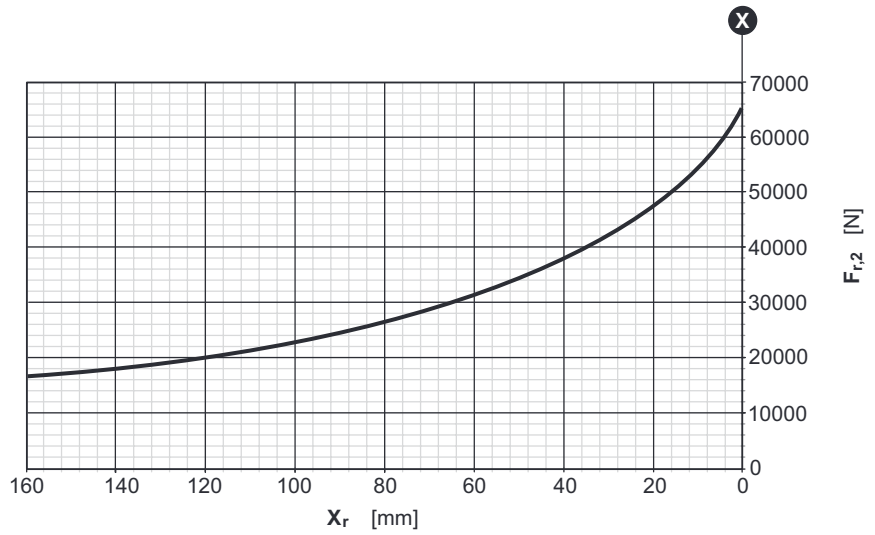
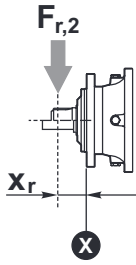

| | | | |
|----|-----|----|-----------|
| RR | 510 | .. | SS |
| RA | | | SC |
| | | | SE |

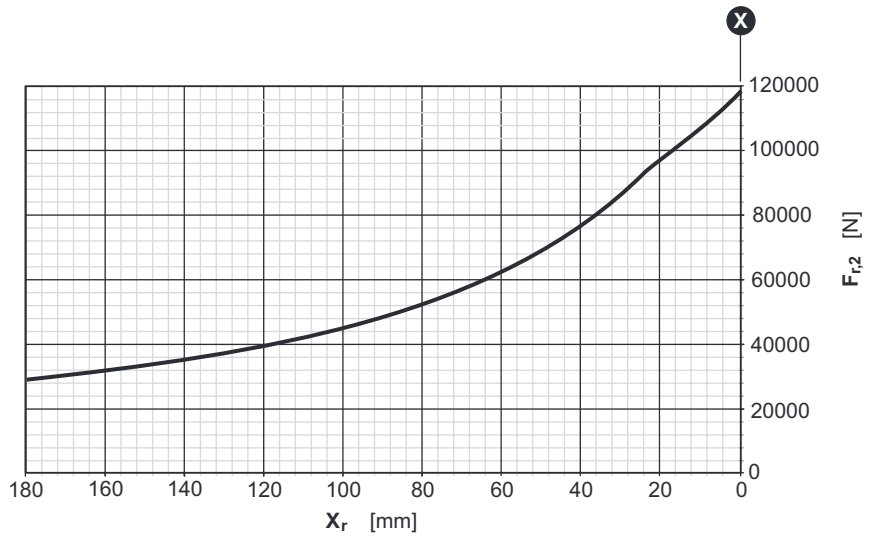
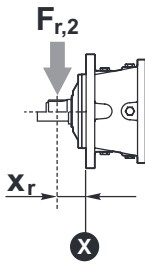

| | | | |
|----|-----|----|-----------|
| RR | 510 | .. | UC |
| RA | | | |

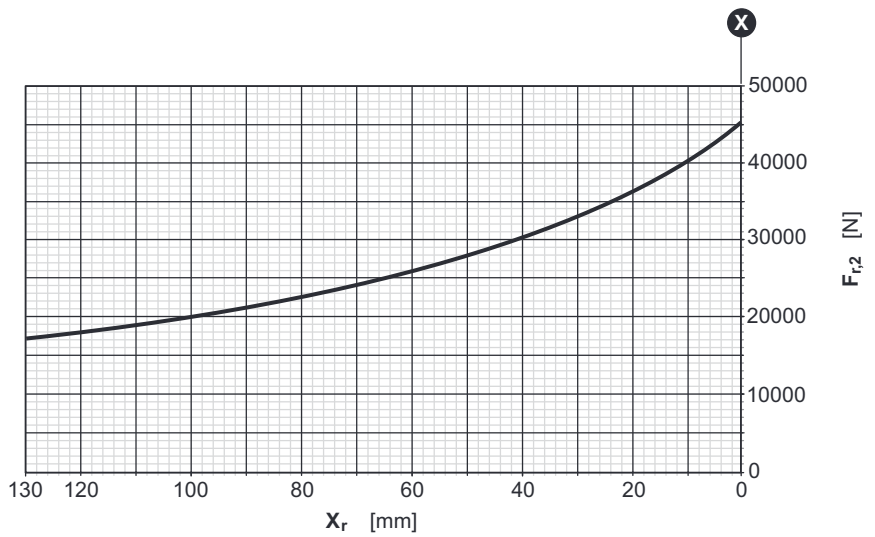
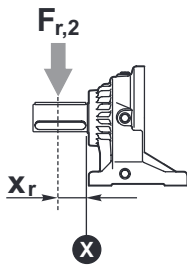



RR 510 .. SI

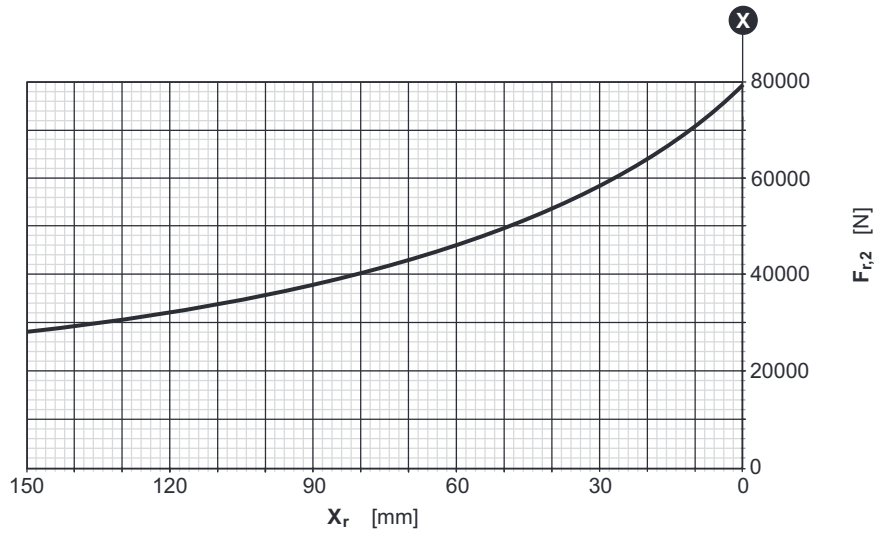
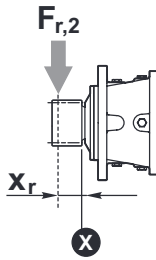

Fattore correttivo k_{r2} / k_{r2} Corrective coefficient / Korrekturfaktor k_{r2}
 Facteur correctif k_{r2} / Factor de corrección k_{r2} / Fator corretivo k_{r2}

