



1700

IT EN DE FR ES PT

RR1700

..

i



	i 1/...	T ₂ [Nm]						n _{1max} [min ⁻¹]	T _{2max} [Nm]	P _t [kW]
		n ₂ x h								
		10000 (10 ⁴)	25000 (2.5 · 10 ⁴)	50000 (5 · 10 ⁴)	100000 (10 ⁵)	500000 (5 · 10 ⁵)	1000000 (10 ⁶)			
RR1700	3.90 4.41 5.14 6.27	25000 22700 19910 16730	23550 21390 16560 13910	21350 20470 14410 12100	18700 18340 13250 11510	13740 13470 12010 10430	11160 10940 10800 9990	2000	26500	48.1 (M.../B...) 78.6 (UC) 25.8 (FS)
RR1700D	13.26 15.60 17.64 22.05 25.08 31.35 43.89	20320 21370 22700 17420 16730 16730 16390	19620 18120 20350 15550 13910 13910 13910	18760 17370 19500 14900 12100 12100 12100	17220 16650 18340 14280 11510 11510 11510	10630 11840 12910 12590 10430 10430 10430	8630 9620 10490 10230 9990 9990 9990	3500	26500	28.1 (M.../B...) 43.5 (UC) 16.9(FS)
RR1700T	53.04 62.40 78.00 90.48 109.20 136.50 175.56 219.45 254.56 307.23	20320 21370 21370 21370 20770 15760 16730 16730 16730 16390	19620 18120 18120 18120 18120 13850 13910 13910 13910 13910	18760 17370 17370 17370 17370 13270 12100 12100 12100 12100	17220 16650 16650 16650 16650 12720 11510 11510 11510 11510	10630 11840 11840 11840 11840 11520 10430 10430 10430 10430	8630 9620 9620 9620 9620 9380 9990 9990 9990 9990	3500	26500	20.6 (M.../B...) 31 (UC) 13 (FS)
RR1700Q	370.97 449.28 561.60 651.46 786.24 814.32 889.06 982.80 1264.03 1580.04 1832.85 2212.06	21370 21370 21370 21370 20770 15760 22700 15760 16730 16730 16730 16390	18120 18120 18120 18120 18120 13850 20350 13850 13910 13910 13910 13910	17370 17370 17370 17370 17370 13270 19500 13270 12100 12100 12100 12100	16650 16650 16650 16650 16650 12720 18340 11520 11510 11510 11510 11510	11840 11840 11840 11840 11840 11520 12910 11520 10430 10430 10430 10430	9620 9620 9620 9620 9620 9380 10490 9380 9990 9990 9990 9990	3500	26500	16.5 (M.../B...) 24.3 (UC) 10.7 (FS)



RA1700 .. **i**



	i	T ₂ [Nm]						n _{1max} [min ⁻¹]	T _{2max} [Nm]	P _t [kW]	
		n ₂ x h									
		10000 (10 ⁴)	25000 (2.5 · 10 ⁴)	50000 (5 · 10 ⁴)	100000 (10 ⁵)	500000 (5 · 10 ⁵)	1000000 (10 ⁶)				
RA1700 (A)	15.60	6510	5930	5230	4960	3800	3090	3500	26500	38.4 (M...) 53.8 (UC) 27.1 (FS)	
	17.64	7350	6560	5830	5560	4140	3370				
	20.56	8540	7440	6720	6420	4610	3750				
	25.08	10320	8750	8090	7720	5300	4310				
	(B)	10.64	23860	22960	19630	15940	9840	7990	2500	26500	46.2 (M...) 61.6 (UC) 35 (FS)
		12.03	22700	21390	20470	17380	10720	8710			
		14.02	19910	16560	14410	13250	11940	9700			
		17.10	16730	13910	12100	11510	10430	9990			
RA1700D	35.70	20320	19620	18460	14990	9250	7510	3500	26500	27.4 (M...) 37.8 (UC) 19.9 (FS)	
	40.38	22700	21390	20120	16340	10080	8190				
	53.04	18590	16620	15850	14140	8730	7090				
	62.40	21250	18120	17370	15850	9780	7940				
	70.56	22700	20350	19500	17280	10660	8660				
	88.20	17420	15550	14900	14280	12460	10120				
	100.32	16730	13910	12100	11510	10430	9990				
	125.40	16730	13910	12100	11510	10430	9990				
175.56	16390	13910	12100	11510	10430	9990					
RA1700T	200.93	21370	18120	17370	14910	9200	7470	3500	26500	19.3 (M...) 27.2 (UC) 13.6 (FS)	
	251.16	21370	18120	17370	16650	10760	8740				
	291.35	21370	18120	17370	16650	11840	9620				
	351.62	20770	18120	17370	16650	11840	9620				
	439.53	15760	13850	13270	12720	11520	9380				
	565.30	16730	13910	12100	11510	10430	9990				
	706.63	16730	13910	12100	11510	10430	9990				
	819.69	16730	13910	12100	11510	10430	9990				
	989.28	16390	13910	12100	11510	10430	9990				
	1054.22	15330	14010	13420	12870	11660	10000				
	1125.20	10720	9920	9500	9110	8250	7910				
	1272.34	11850	11130	10670	10230	9260	8880				
	1482.95	13600	12860	12320	11810	10700	10250				
	1808.97	16390	13910	12100	11510	10430	9990				



1700

IT EN DE FR ES PT

RR1700 .. i ..

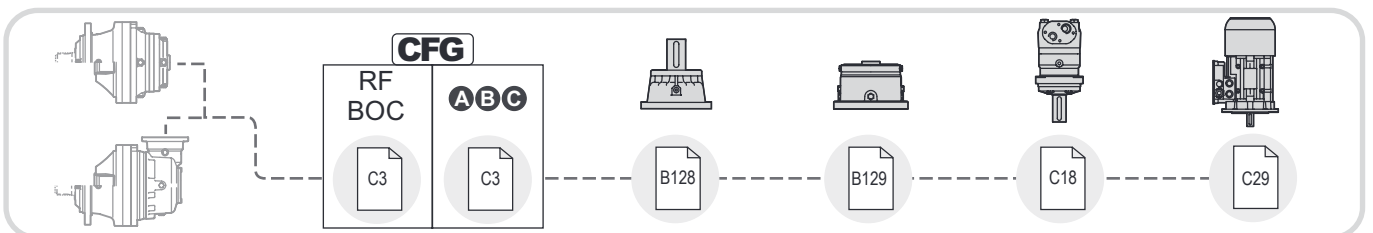
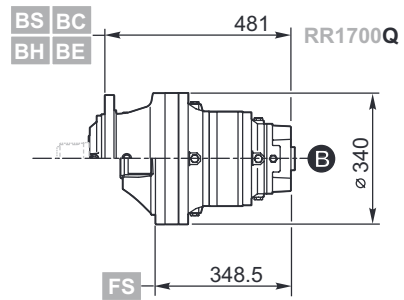
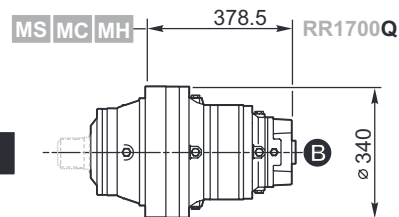
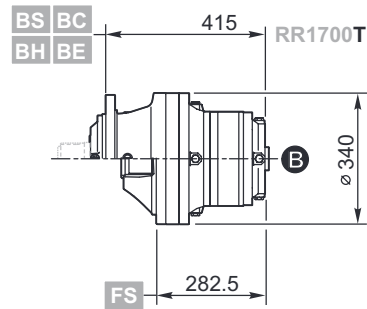
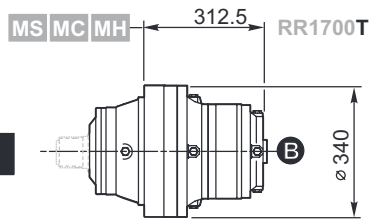
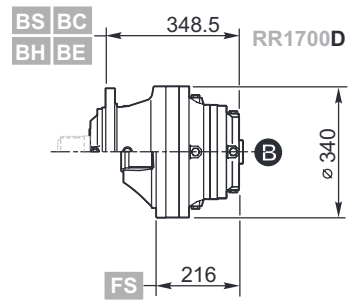
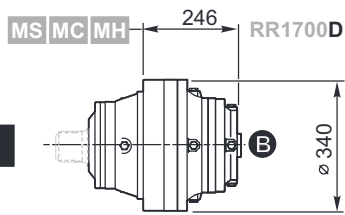
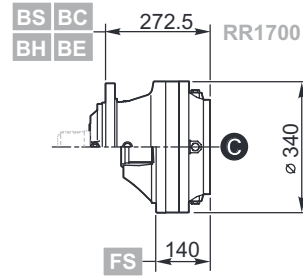
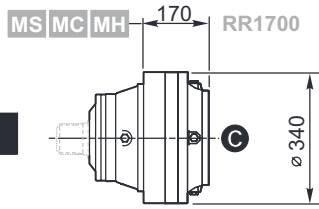

RR1700 .. i ..

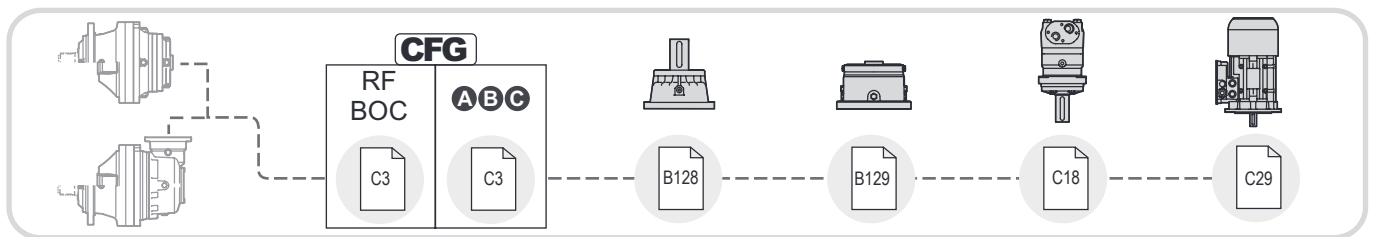
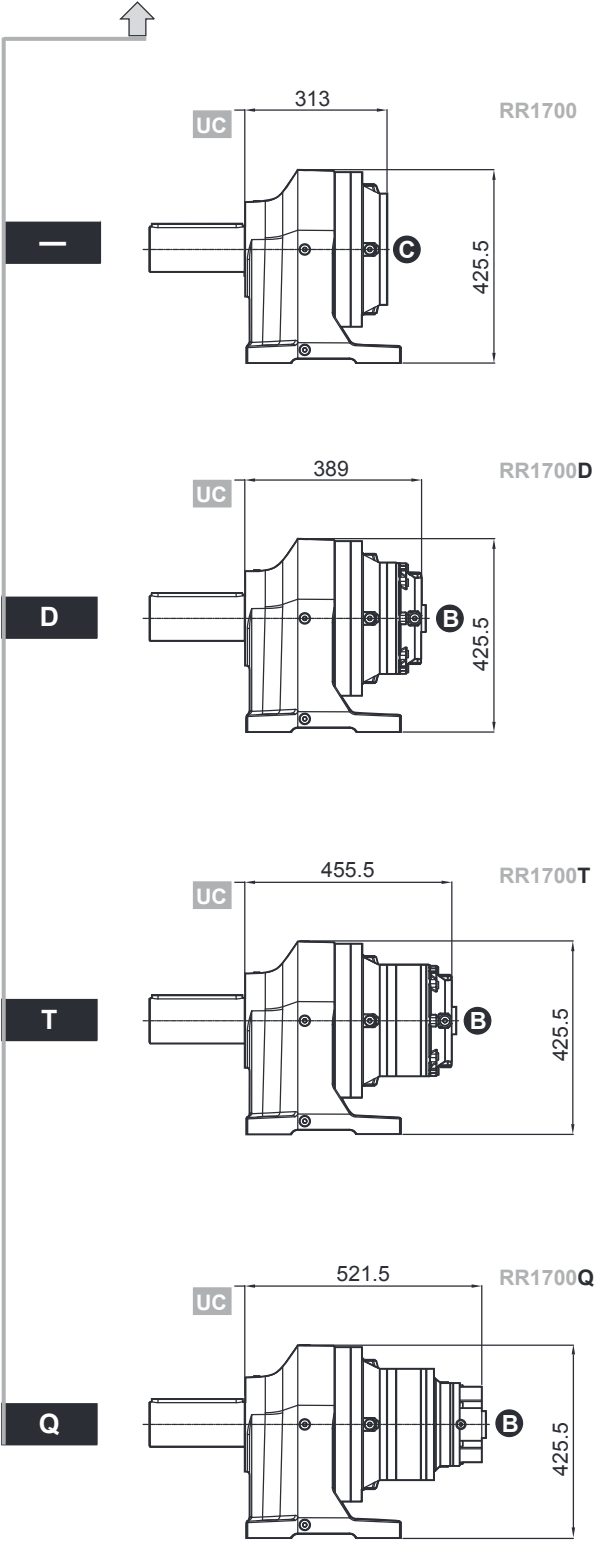



1700

IT EN DE FR ES PT

RA1700 .. i B.. FS

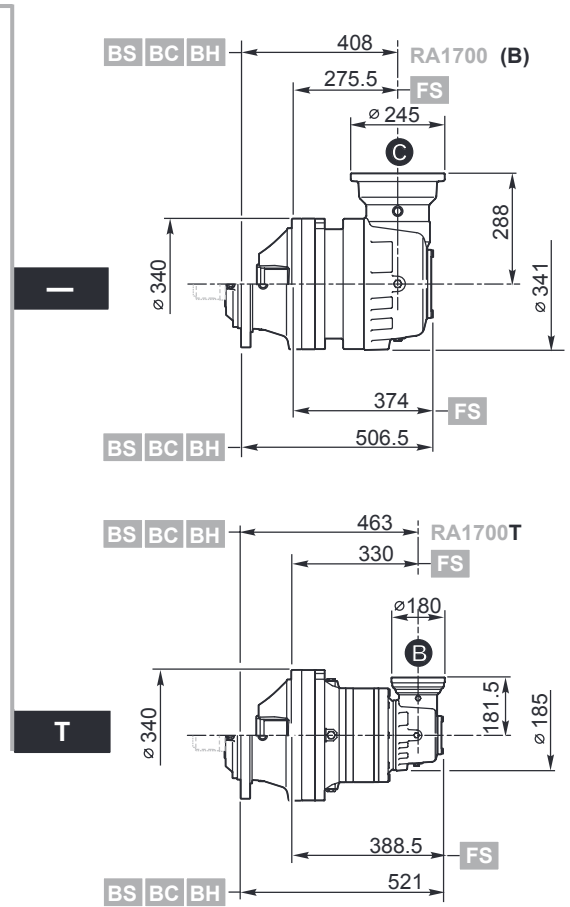
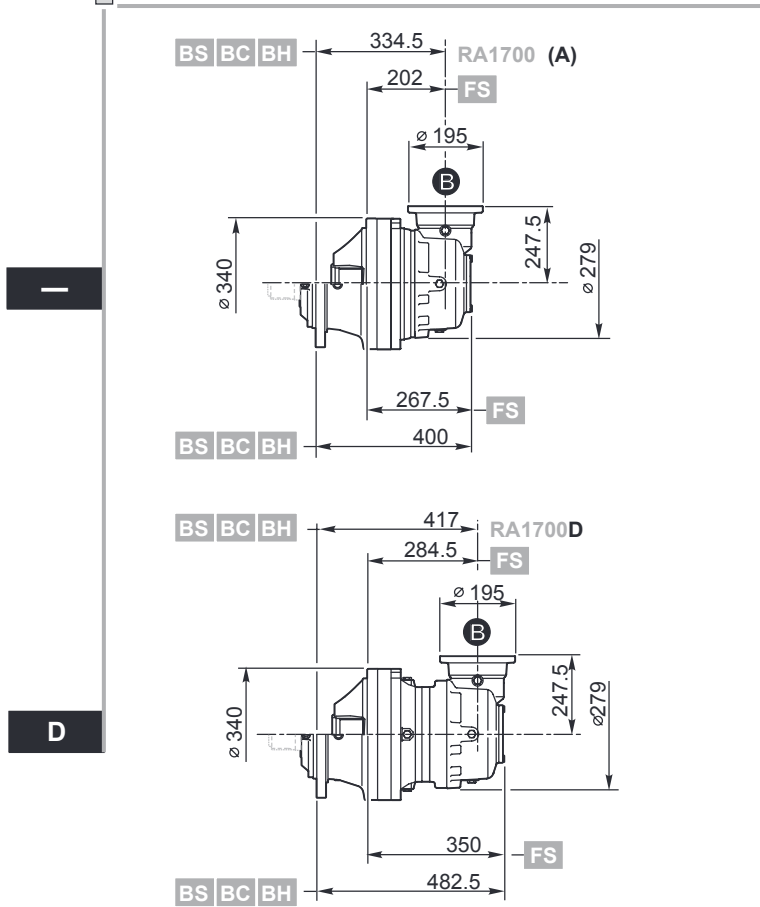

RA1700 .. i M

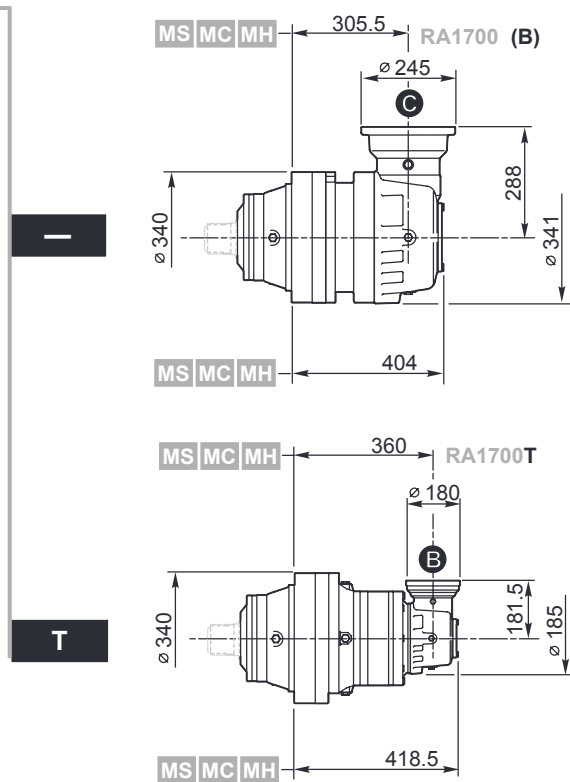
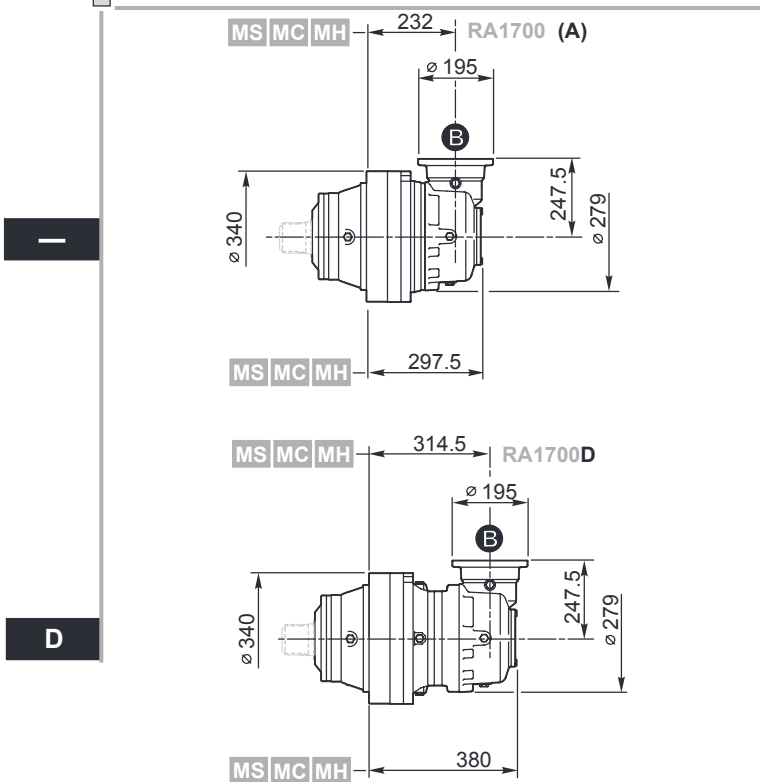



RA1700 .. i UC

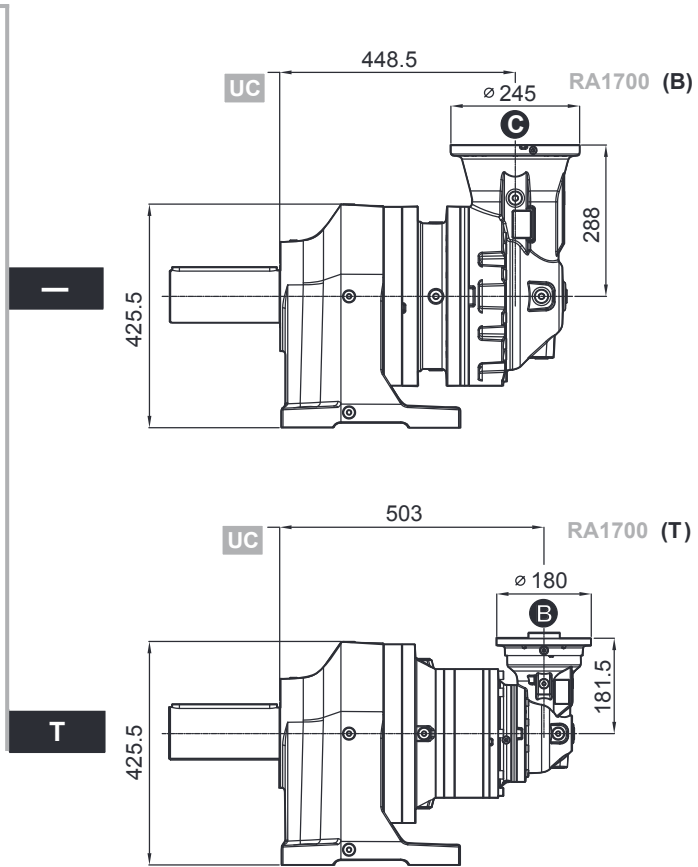
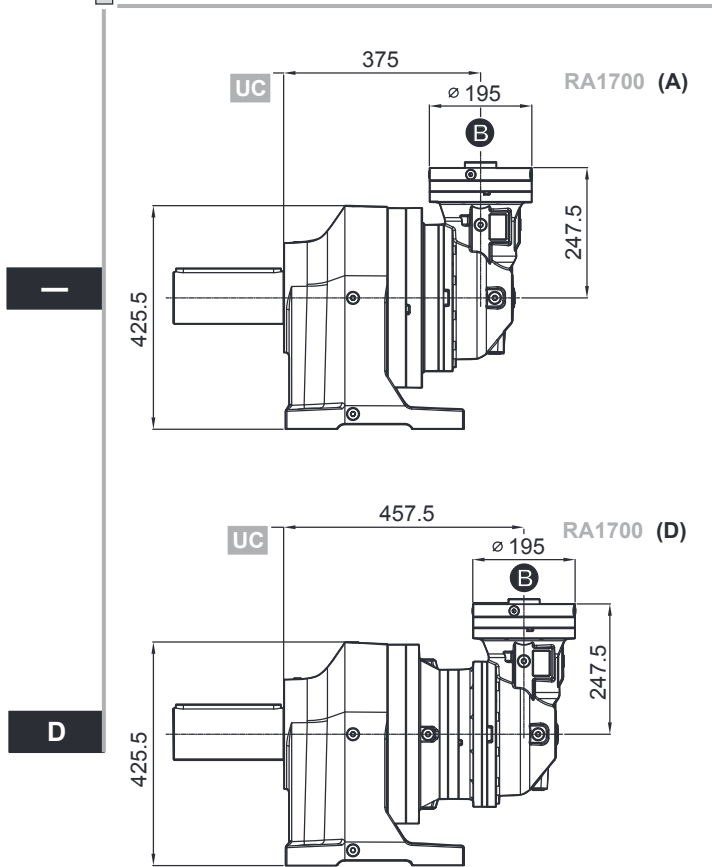

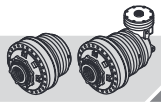





1700

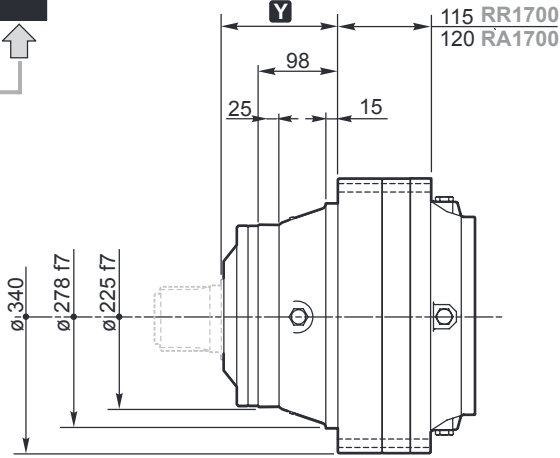



IT EN DEFRES PT

RR1700	..	i	..
RA1700

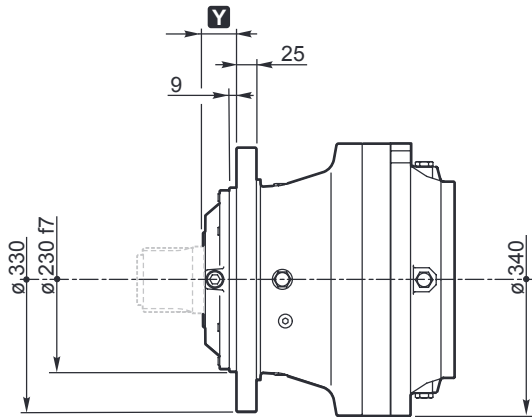

- MS 
- MC 
- MH 



- BS 
- BC 
- BH 
- BE 

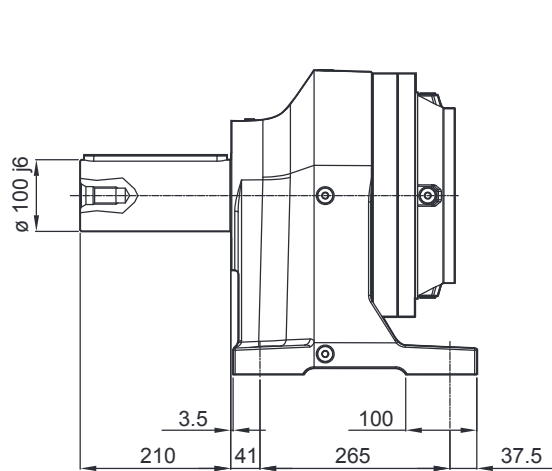

- UC 

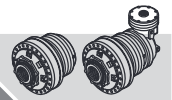

MS
BS

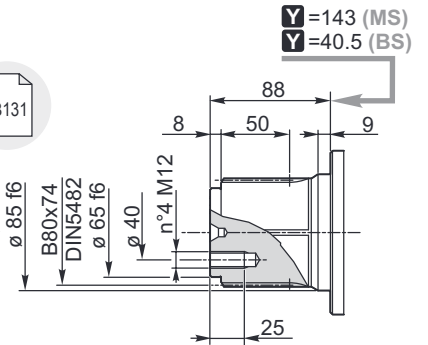
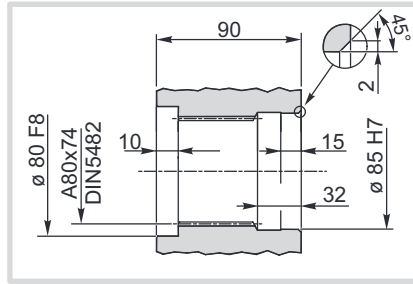
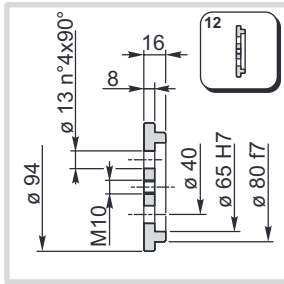

MC
BC
UC

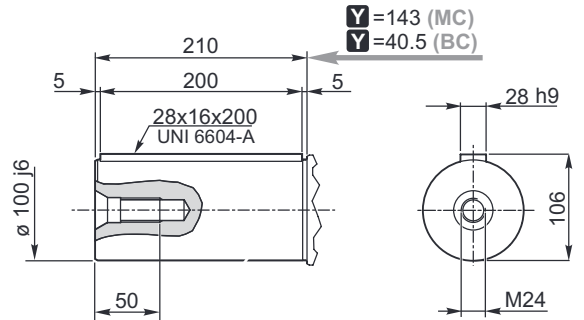
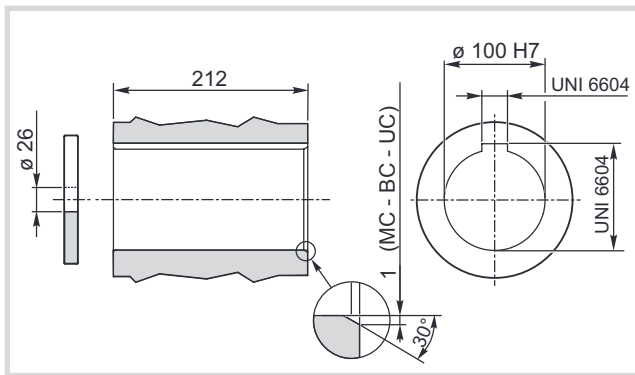

MH
BH

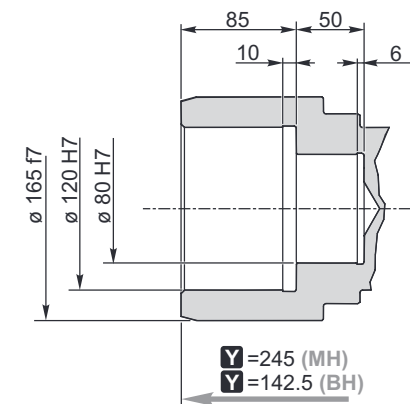
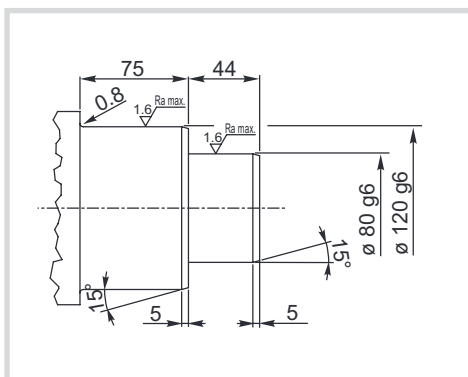

BE

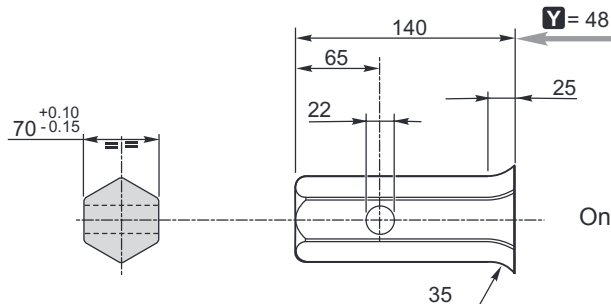

Only for RR1700

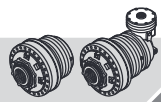

1700

IT EN DE FR ES PT

RR1700
RA1700 .. i **FS**

FS

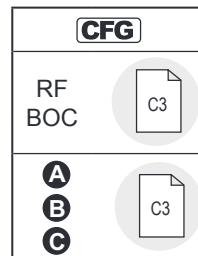
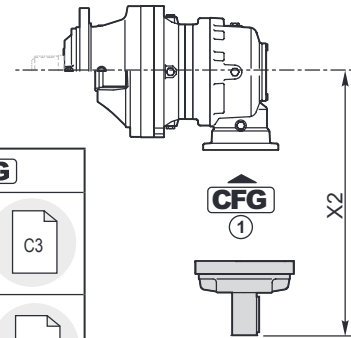
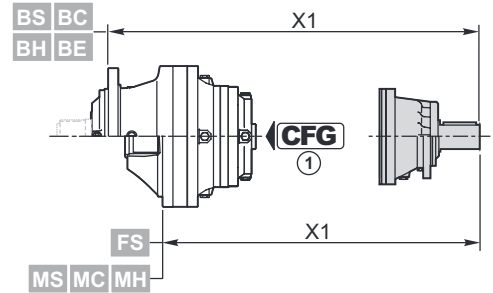
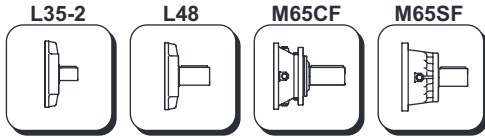
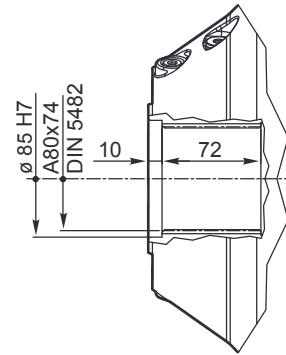
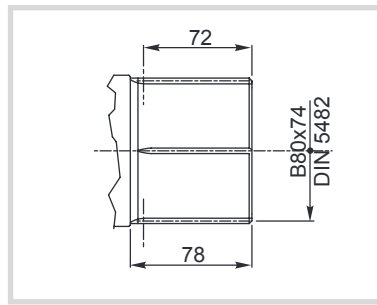
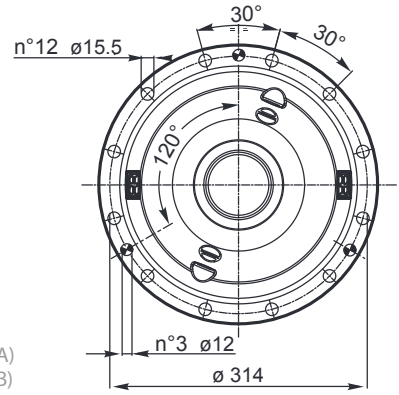
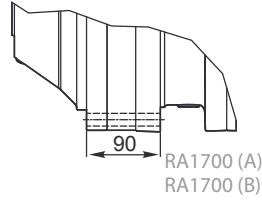
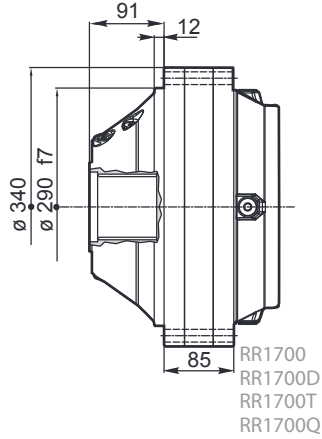

	CFG ①		code	X1
RR1700	-	P65CF	154-2404	482 (M...) 452 (FS) 584.5 (B...)
RR1700D	RF	M65SF	154B4249	430.5 (M...) 400.5 (FS) 533 (B...)
	RF	M65CF	154-2407	453.5 (M...) 423.5 (FS) 556 (B...)
	BOC	L48	154B3989	367.5 (M...) 337.5 (FS) 470 (B...)
RR1700T	RF	M65SF	154B4249	497 (M...) 467 (FS) 599.5 (B...)
	RF	M65CF	154-2407	520 (M...) 490 (FS) 622.5 (B...)
	BOC	L48	154B3989	434 (M...) 404 (FS) 536.5 (B...)
RR1700Q	BOC	L35-2	154-2190M1	468 (M...) 438 (FS) 570.5 (B...)

	CFG ①		code	X2
RA1700 (A)	BOC	L48	154B3989	347.5
RA1700 (B)	-	P65CF	154-2404	600
RA1700D	BOC	L48	154B3989	347.5
RA1700T	BOC	L35-2	154-2190M1	270.5

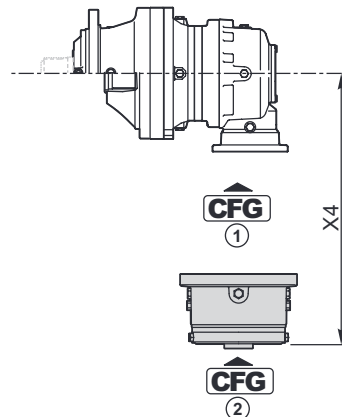
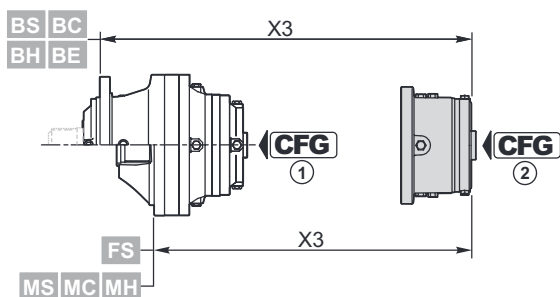
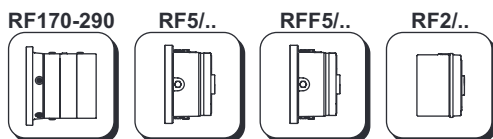

RF170÷290	CFG ①	T _f [Nm]	CFG ②		
			C		
			code	X3	X4
RR1700	RF	1700	154B9766M2	367 (M...) 337 (FS) 470 (B)	-
		2000	154B9767M2		
		2300	154B9768M2		
		2900	154B9769M2		
RA1700 (B)	-	1700	154B9766M3	-	485
		2000	154B9767M3		
		2300	154B9768M3		
		2900	154B9769M3		

RF5/..	CFG ①	T _f [Nm]	CFG ②						
			B			OMTS 12/24 z16	OMVS 10/20 z16		
			code	X3	X4	code	code	X3	X4
RR1700D	RF	210	154-2872	336.5 (M...) 306.5 (FS) 438.5 (B...)	-	154-2879	154-2886	340.2 (M...) 310.2 (FS) 442.2 (B...)	-
		290	154-2873			154-2880	154-2887		
		430	154-2874			154-2881	154-2888		
		650	154-2875			154-2882	154-2889		
		850	154-2876			154-2883	154-2890		
		1100	154-2877			154-2884	154-2891		
RR1700T	RF	210	154-2872	403 (M...) 373 (FS) 505.5 (B...)	-	154-2879	154-2886	406.7 (M...) 376.7 (FS) 509.2 (B...)	-
		290	154-2873			154-2880	154-2887		
		430	154-2874			154-2881	154-2888		
		650	154-2875			154-2882	154-2889		
		850	154-2876			154-2883	154-2890		
		1300	154-2878			154-2884	154-2891		

RFF5/..	CFG ①	T _f [Nm]	CFG ②						
			B			OMTS 12/24 z16	OMVS 10/20 z16		
			code	X3	X4	code	code	X3	X4
RA1700 (A)	RF	210	154-2893	-	316.6	154-5338	154-5345	-	320.5
		290	154-2894			154-5339	154-5346		
		430	154-2895			154-5340	154-5347		
		650	154-2896			154-5341	154-5348		
		850	154-2897			154-5342	154-5349		
		1100	154-2898			154-5343	154-5350		
RA1700D	RF	210	154-2893	-	316.6	154-5338	154-5345	-	320.5
		290	154-2894			154-5339	154-5346		
		430	154-2895			154-5340	154-5347		
		650	154-2896			154-5341	154-5348		
		850	154-2897			154-5342	154-5349		
		1300	154-2899			154-5344	154-5351		

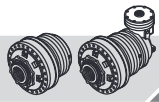

1700

IT EN DE FR ES PT

RF2/..	CFG ①	T _f [Nm]	CFG ②						
			B		OMP/OMR SAE A 2B Ø 25	OMP/OMR SAE A 2B 1" 6B	OMP/OMR SAE A 4B Ø 25	OMP/OMR SAE A 4B 1" 6B	X3
			code	X3	code	code	code	code	
RR1700D	RF	70	154B9195	309 (M...) 279 (FS) 411.5 (B...)	154B9195M10	—	154B9195M16	154B9195M17	299 (M...) 269 (FS) 401.5 (B...)
		140	154B9196		154B9196M10	—	154B9196M16	154B9196M17	
		210	154B9197		154B9197M10	—	154B9197M16	154B9197M17	
		320	154B9198		154B9198M10	—	154B9198M16	154B9198M17	
		430	154B9199		154B9199M10	—	154B9199M16	154B9199M17	
		600	154B9200		154B9200M10	—	154B9200M16	154B9200M17	
RR1700T	RF	70	154-2345	375.5 (M...) 345.5 (FS) 478 (B...)	154-2345M10	154-2345M11	154-2345M16	154-2345M17	365.5 (M...) 335.5 (FS) 468 (B...)
		140	154-2346		154-2346M10	154-2346M11	154-2346M16	154-2346M17	
		210	154-2347		154-2347M10	154-2347M11	154-2347M16	154-2347M17	
		320	154-2348		154-2348M10	154-2348M11	154-2348M16	154-2348M17	
		430	154-2349		154-2349M10	154-2349M11	154-2349M16	154-2349M17	
		600	154B9186		154B9186M10	154B9186M11	154B9186M16	154B9186M17	
RR1700Q	RF	70	154-2838M1	417 (M...) 387 (FS) 519.5 (B...)	154-2863	154-2863M11	154-2635	154-2635M11	407 (M...) 377 (FS) 509.5 (B...)
		140	154-2839M1		154-2864	154-2864M11	154-2636	154-2636M11	
		210	154-2840M1		154-2865	154-2865M11	154-2637	154-2637M11	
		320	154-2841M1		154-2866	154-2866M11	154-2638	154-2638M11	
		430	154-2842M1		154-2867	154-2867M11	154-2639	154-2639M11	
		600	154B8962M1		154B9665	154B9665M11	154B9666	154B9666M11	

	CFG ①	T _f [Nm]	CFG ②						
			B		OMP/OMR SAE A 2B Ø 25	OMP/OMR SAE A 2B 1" 6B	OMP/OMR SAE A 4B Ø 25	OMP/OMR SAE A 4B 1" 6B	X4
			code	X4	code	code	code	code	
RA1700 (A)	RF	70	154F2991	285.3					
		140	154F1890						
		210	154F2961						
		320	154B3591						
		430	154B3592						
		600	154F2992						
RA1700D	RF	70	154F2991	285.3					
		140	154F1890						
		210	154F2961						
		320	154B3591						
		430	154B3592						
		600	154F2992						
RA1700T	RF	70	154-2838M12	223.8	154-2863M12	154-2863M13	154-2635M12		213.8
		140	154-2839M12		154-2864M12	154-2864M13	154-2636M12		
		210	154-2840M12		154-2865M12	154-2865M13	154-2637M12		
		320	154-2841M12		154-2866M12	154-2866M13	154-2638M12		
		430	154-2842M12		154-2867M12	154-2867M13	154-2639M12		
		600	154B8962M12		154B9665M12	154B9665M13	154B9666M12		

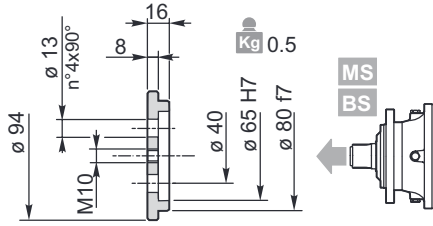
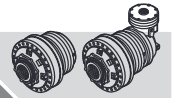

154-3062

Materiale / Material / Material / Matériau / Material / Material:
 Acciaio / Steel / Stahl / Acier / Acero / Aço
 C40 EN 10083-1 (1.1186)

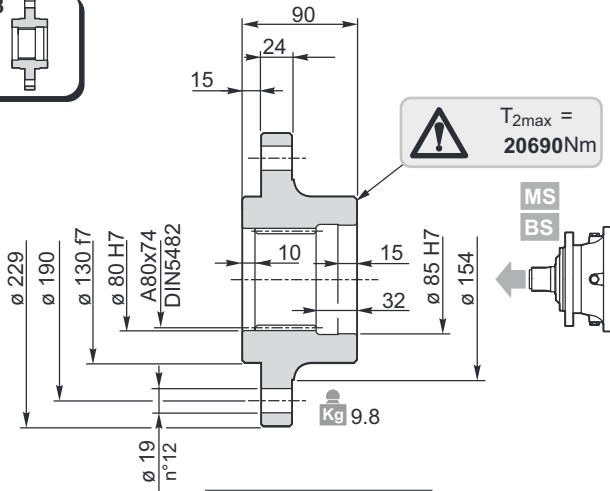
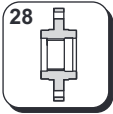

154-3359

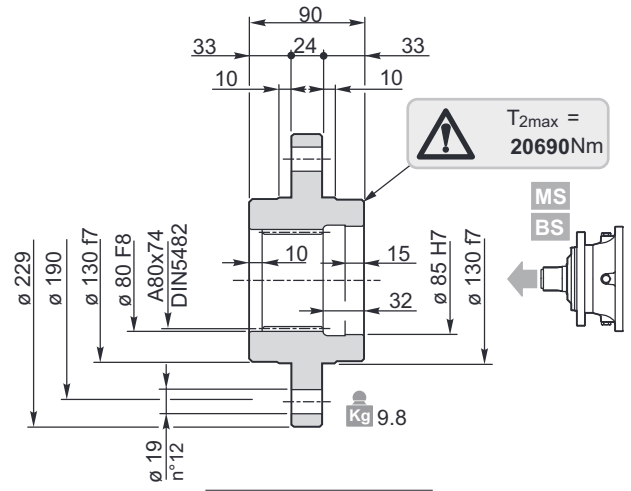

154-3112

Materiale / Material / Material / Matériau / Material / Material:
 Acciaio / Steel / Stahl / Acier / Acero / Aço EN 10083-1-C40 (1.1186)

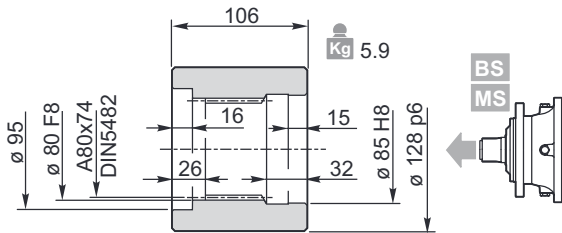

154-3093

Materiale / Material / Material / Matériau / Material / Material:
 Acciaio / Steel / Stahl / Acier / Acero / Aço 39NiCrMo3 UNI 7845 (1.6511)

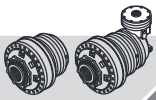

1700

IT EN DE FR ES PT



Materiale / Material / Material
 Matériau / Material / Material
 Acciaio / Steel / Stahl / Acier / Acero / Aço
 39NiCrMo3 UNI 7845 (1.6511)

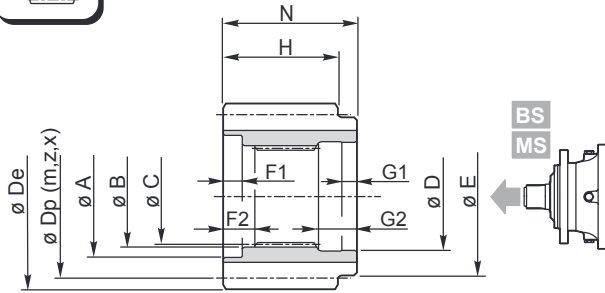

	A	B	C	D	E	F1	F2	G1	G2	N	m	z	x	H	Dp	De	Code
BS MS	96	80 F8	DIN5482 A80x74	85 H8	124	15	25	12	30	105	8	17	0.5	90	136	159	154-3071
	96	80 F8	DIN5482 A80x74	85 H8	124	15	25	12	30	105	10	12	0.425	90	120	146	154-3081
	96	80 F8	DIN5482 A80x74	85 H8	105	15	25	12	30	105	10	12	0.5	90	120	148	154B3834
	96	80 F7	DIN5482 A80x74	85 H7	124	15	25	12	30	105	10	15	0.5	90	150	180	154L02183
	96	80 F8	DIN5482 A80x74	85 H8	124	15	25	12	30	105	10	18	0	90	180	198.5	154-3044
	96	80 F8	DIN5482 A80x74	85 H8	130	15	25	12	30	105	12	14	0.25	90	168	194.5	154-3080

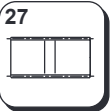

Kg 6.5

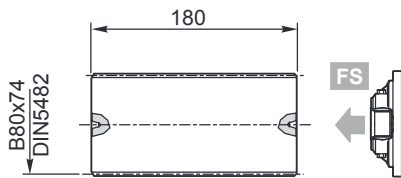

154-3054

Materiale / Material / Material
 Matériau / Material / Material:
 Acciaio / Steel / Stahl / Acier / Acero / Aço
 39NiCrMo3 UNI 7845 (1.6511)

T_{2max} = 21100Nm

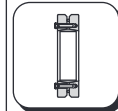

Kg 22

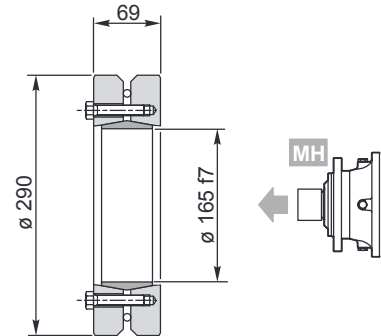

154F6065

C40

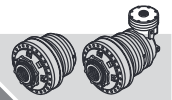

RR	1700	..	MS
RA			MC

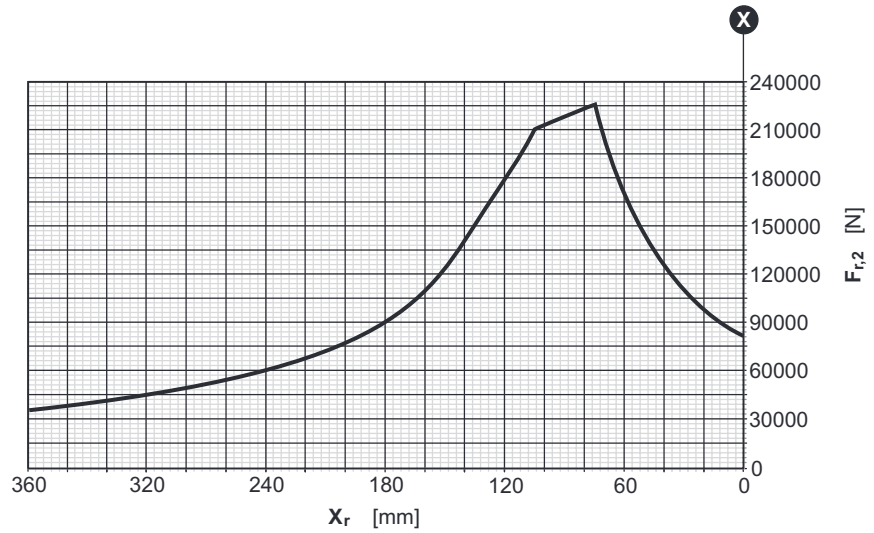
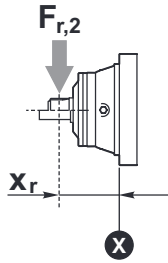

RR	1700	..	BS
RA			BC

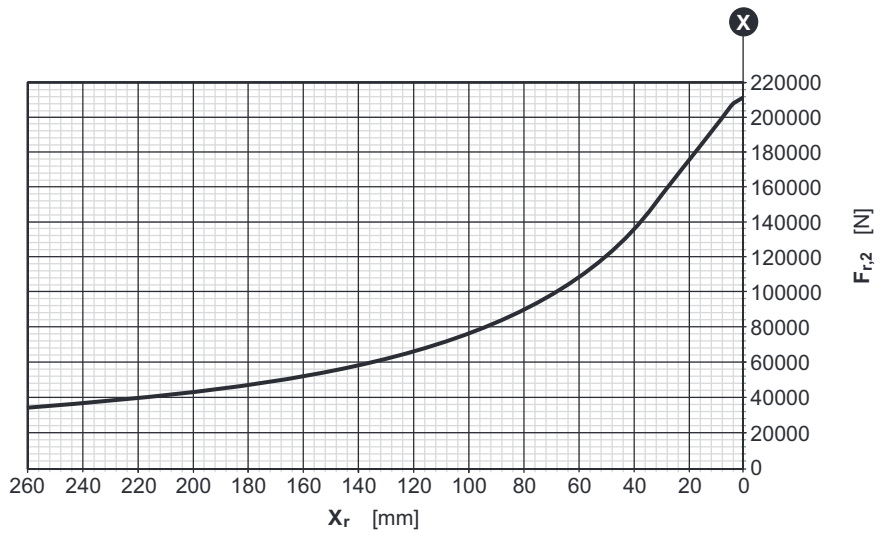
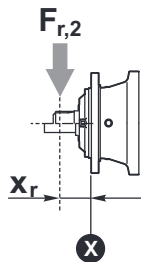

RR	1700	..	BE
----	------	----	-----------

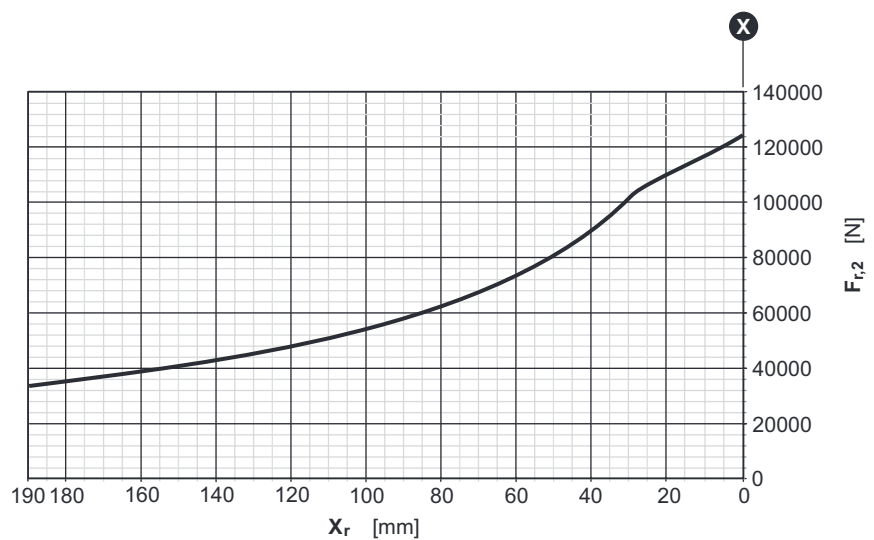
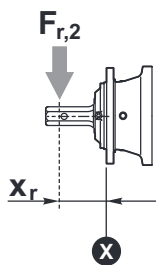

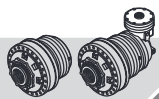

1700

IT EN DE FR ES PT

RR 1700 .. UC

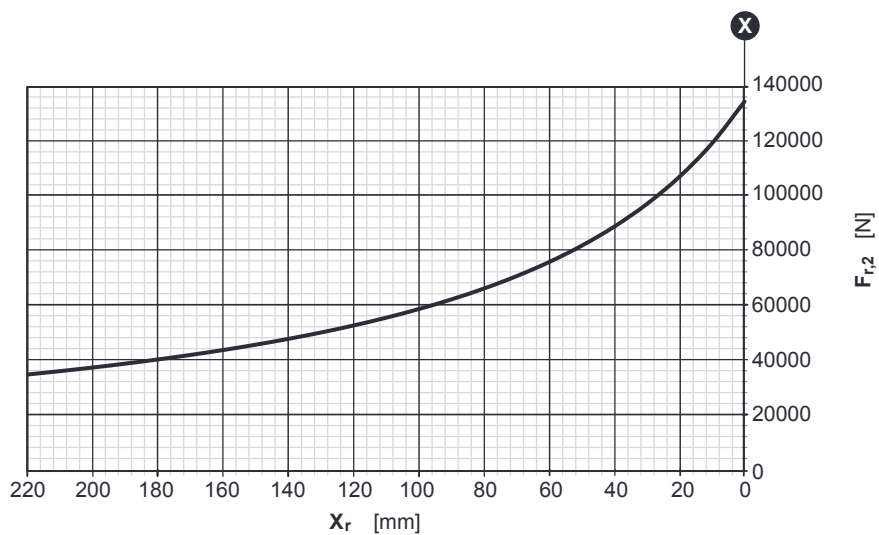
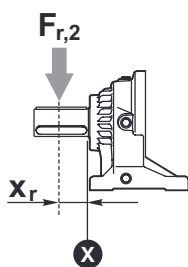

Fattore correttivo k_{r2} / k_{r2} Corrective coefficient / Korrekturfaktor k_{r2}
 Facteur correctif k_{r2} / Factor de corrección k_{r2} / Fator corretivo k_{r2}

