



1010

IT EN DE FR ES PT

RR1010

..

i



| | i 1/... | T ₂ [Nm] | | | | | | n _{1max} [min ⁻¹] | T _{2max} [Nm] | P _t [kW] |
|----------------|----------------|-----------------------------|-----------------------------------|---------------------------------|------------------------------|----------------------------------|-------------------------------|---|---------------------------|---------------------------------------|
| | | n ₂ x h | | | | | | | | |
| | | 10000 (10 ⁴) | 25000 (2.5 · 10 ⁴) | 50000 (5 · 10 ⁴) | 100000 (10 ⁵) | 500000 (5 · 10 ⁵) | 1000000 (10 ⁶) | | | |
| RR1010 | 4.00 | 17500 | 16310 | 15600 | 13870 | 10130 | 8230 | 2500 | 17500 | 38.6 (M...) 45.7 (UC) 21(FS) |
| | 5.00 | 15970 | 13490 | 11880 | 10940 | 9870 | 8020 | | | |
| | 5.80 | 14680 | 12400 | 10920 | 10270 | 9310 | 7850 | | | |
| | 7.00 | 9980 | 8420 | 7470 | 7160 | 6490 | 6220 | | | |
| RR1010D | 13.60 | 17500 | 16310 | 15600 | 13870 | 10130 | 8230 | 3500 | 17500 | 23.3 (M...) 26.9 (UC) 14.4 (FS) |
| | 16.00 | 17500 | 16310 | 15600 | 13870 | 10130 | 8230 | | | |
| | 20.00 | 16090 | 14190 | 13590 | 13030 | 10130 | 8230 | | | |
| | 23.20 | 14160 | 12780 | 12240 | 11740 | 10130 | 8230 | | | |
| | 29.00 | 15970 | 13490 | 11880 | 10940 | 9870 | 8020 | | | |
| | 35.00 | 13250 | 12520 | 11880 | 10940 | 9870 | 8020 | | | |
| | 40.60 | 14680 | 12400 | 10920 | 10270 | 9310 | 7850 | | | |
| | 49.00 | 9980 | 8420 | 7470 | 7160 | 6490 | 6220 | | | |
| RR1010T | 64.00 | 17500 | 16310 | 15600 | 13870 | 10130 | 8230 | 3500 | 17500 | 17.3 (M...) 19.8 (UC) 11.4 (FS) |
| | 80.00 | 17500 | 16310 | 15600 | 13870 | 10130 | 8230 | | | |
| | 92.80 | 17500 | 16310 | 15600 | 13870 | 10130 | 8230 | | | |
| | 116.00 | 16090 | 14190 | 13590 | 13030 | 10130 | 8230 | | | |
| | 140.00 | 16090 | 14190 | 13590 | 13030 | 10130 | 8230 | | | |
| | 168.20 | 15970 | 13490 | 11880 | 10940 | 9870 | 8020 | | | |
| | 203.00 | 15970 | 13490 | 11880 | 10940 | 9870 | 8020 | | | |
| | 235.48 | 14680 | 12400 | 10920 | 10270 | 9310 | 7850 | | | |
| | 284.20 | 14680 | 12400 | 10920 | 10270 | 9310 | 7850 | | | |
| | 343.00 | 9980 | 8420 | 7470 | 7160 | 6490 | 6220 | | | |
| | RR1010Q | 380.48 | 17500 | 16310 | 15600 | 13870 | 10130 | | | |
| 475.60 | | 16090 | 14190 | 13590 | 13030 | 10130 | 8230 | | | |
| 576.00 | | 17500 | 16310 | 15600 | 13870 | 10130 | 8230 | | | |
| 668.16 | | 17500 | 16310 | 15600 | 13870 | 10130 | 8230 | | | |
| 835.20 | | 16090 | 14190 | 13590 | 13030 | 10130 | 8230 | | | |
| 1008.00 | | 16090 | 14190 | 13590 | 13030 | 10130 | 8230 | | | |
| 1211.04 | | 15970 | 13490 | 11880 | 10940 | 9870 | 8020 | | | |
| 1461.60 | | 15970 | 13490 | 11880 | 10940 | 9870 | 8020 | | | |
| 1695.46 | | 14680 | 12400 | 10920 | 10270 | 9310 | 7850 | | | |
| 2046.24 | | 14680 | 12400 | 10920 | 10270 | 9310 | 7850 | | | |
| 2469.60 | | 9980 | 8420 | 7470 | 7160 | 6490 | 6220 | | | |



RA1010 .. **i**



| | i | T ₂ [Nm] | | | | | | n _{1max} [min ⁻¹] | T _{2max} [Nm] | P _t [kW] | |
|----------------|------------|-----------------------------|-----------------------------------|---------------------------------|------------------------------|----------------------------------|-------------------------------|---|---------------------------|------------------------|---------------------------------------|
| | | n ₂ x h | | | | | | | | | |
| | | 10000 (10 ⁴) | 25000 (2.5 · 10 ⁴) | 50000 (5 · 10 ⁴) | 100000 (10 ⁵) | 500000 (5 · 10 ⁵) | 1000000 (10 ⁶) | | | | |
| RA1010 | (A) | 16.00 | 6680 | 6050 | 5340 | 5080 | 3870 | 3140 | 3500 | 17500 | 32.8 (M...) 36.5 (UC) 23.9 (FS) |
| | | 20.00 | 8310 | 7270 | 6550 | 6250 | 4520 | 3670 | | | |
| | | 23.20 | 9610 | 8210 | 7520 | 7180 | 5020 | 4080 | | | |
| | | 28.00 | 9980 | 8420 | 7470 | 7160 | 5720 | 4650 | | | |
| | (B) | 10.91 | 17500 | 16310 | 15600 | 13870 | 10010 | 8130 | 2500 | 17500 | 40.9 (M...) 44.5 (UC) 32 (FS) |
| | | 13.64 | 15970 | 13490 | 11880 | 10940 | 9870 | 8020 | | | |
| | | 15.82 | 14680 | 12400 | 10920 | 10270 | 9310 | 7850 | | | |
| | | 19.09 | 9980 | 8420 | 7470 | 7160 | 6490 | 6220 | | | |
| RA1010D | | 54.40 | 17500 | 16310 | 15600 | 13870 | 8880 | 7220 | 3500 | 17500 | 24.2 (M...) 26.6 (UC) 18.2 (FS) |
| | | 64.00 | 17500 | 16310 | 15600 | 13870 | 9950 | 8090 | | | |
| | | 80.00 | 16090 | 14190 | 13590 | 13030 | 10130 | 8230 | | | |
| | | 92.80 | 14160 | 12780 | 12240 | 11740 | 10130 | 8230 | | | |
| | | 116.00 | 15970 | 13490 | 11880 | 10940 | 9870 | 8020 | | | |
| | | 140.00 | 13250 | 12520 | 11880 | 10940 | 9870 | 8020 | | | |
| | | 162.40 | 14680 | 12400 | 10920 | 10270 | 9310 | 7850 | | | |
| | | 196.00 | 9980 | 8420 | 7470 | 7160 | 6490 | 6220 | | | |
| RA1010T | | 206.08 | 17500 | 16310 | 15600 | 13870 | 9370 | 7610 | 3500 | 17500 | 16.9 (M...) 18.7 (UC) 12.3 (FS) |
| | | 257.60 | 17500 | 16310 | 15600 | 13870 | 10130 | 8230 | | | |
| | | 298.82 | 17500 | 16310 | 15600 | 13870 | 10130 | 8230 | | | |
| | | 373.52 | 16090 | 14190 | 13590 | 13030 | 10130 | 8230 | | | |
| | | 450.80 | 16090 | 14190 | 13590 | 13030 | 10130 | 8230 | | | |
| | | 541.60 | 15970 | 13490 | 11880 | 10940 | 9870 | 8020 | | | |
| | | 653.66 | 15970 | 13490 | 11880 | 10940 | 9870 | 8020 | | | |
| | | 758.25 | 14680 | 12400 | 10920 | 10270 | 9310 | 7850 | | | |
| | | 915.12 | 14680 | 12400 | 10920 | 10270 | 9310 | 7850 | | | |
| | | 1104.46 | 9980 | 8420 | 7470 | 7160 | 6490 | 6220 | | | |
| | | 1195.26 | 15970 | 13490 | 11880 | 10940 | 9870 | 8020 | | | |
| | | 1386.51 | 14680 | 12400 | 10920 | 10270 | 9310 | 7850 | | | |
| | | 1442.56 | 13250 | 12520 | 11880 | 10940 | 9870 | 8020 | | | |
| | | 1673.37 | 14680 | 12400 | 10920 | 10270 | 9310 | 7850 | | | |
| | | 2019.58 | 9980 | 8420 | 7470 | 7160 | 6490 | 6220 | | | |



RR1010 .. i ..

—

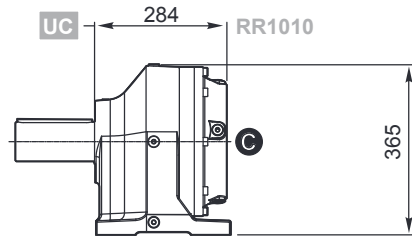
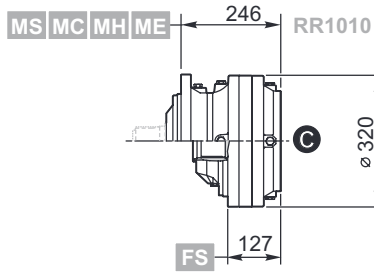

D

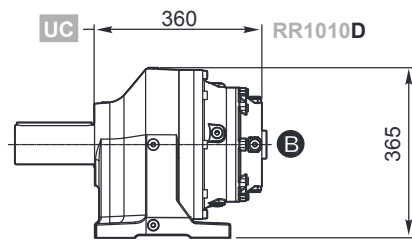
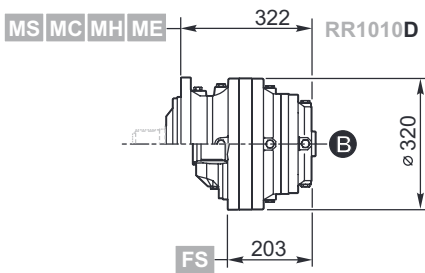

T

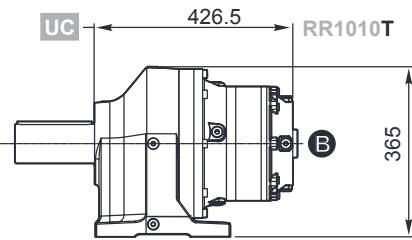
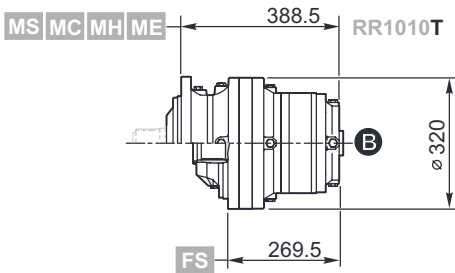

Q

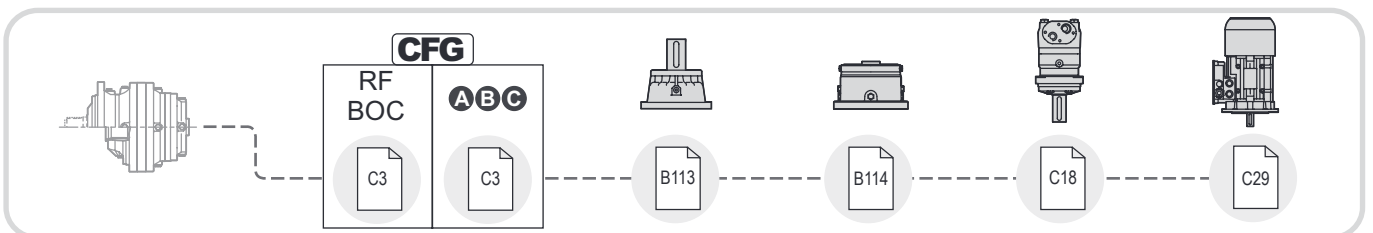
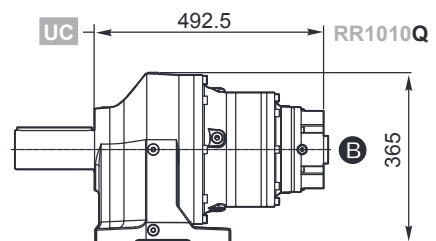
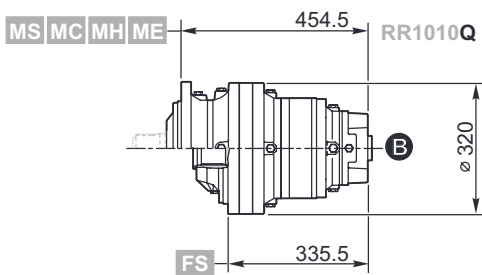



RA1010 .. i ..

I

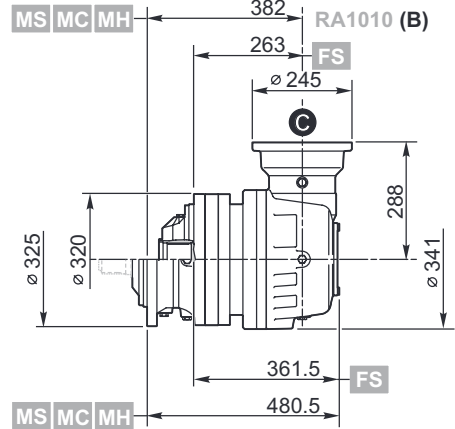
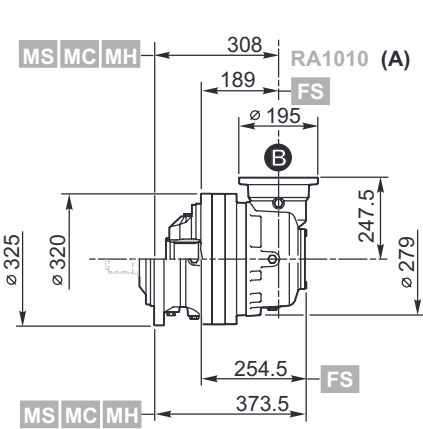

D

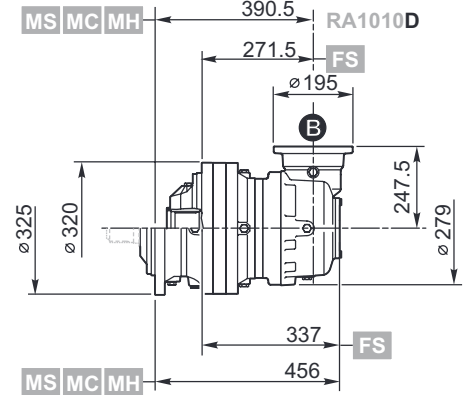

T

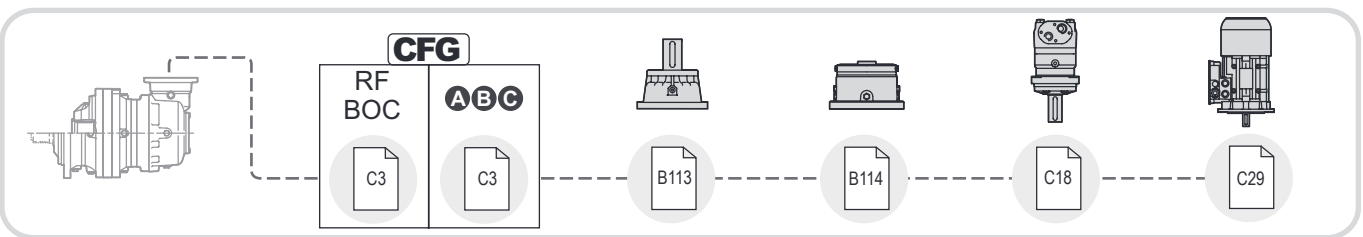
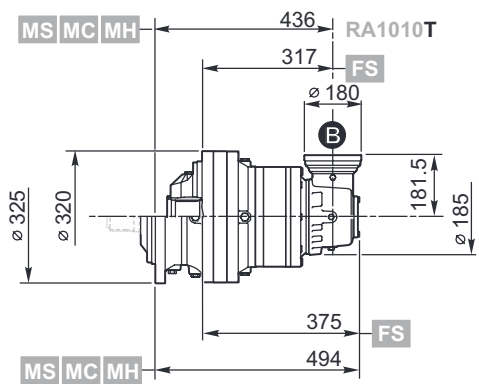



1010

IT EN DE FR ES PT

RA1010 .. i ..

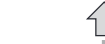

I

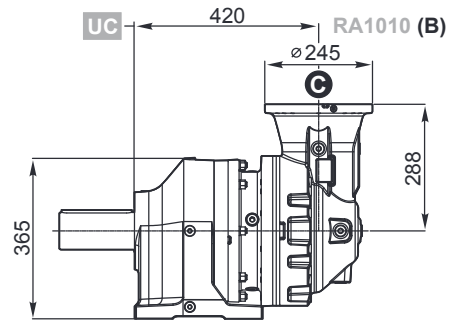
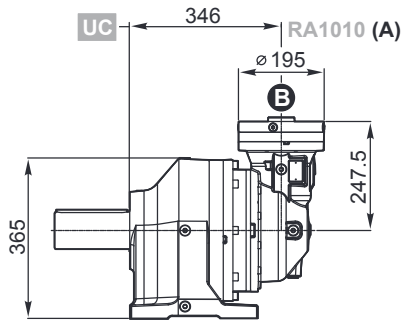

D

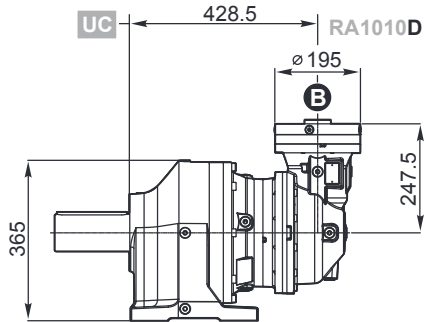

T

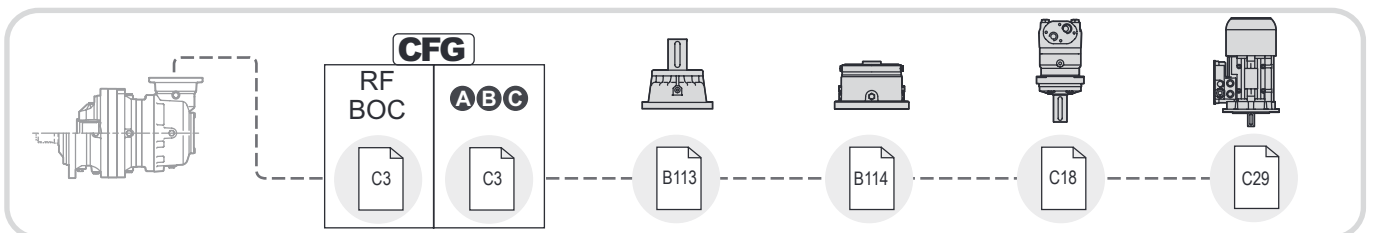
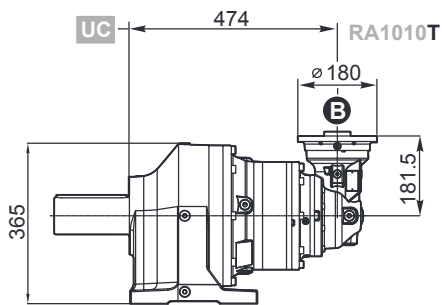

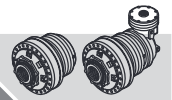

| | | | |
|--------|----|---|----|
| RR1010 | .. | i | .. |
| RA1010 | .. | | .. |



- MS**
- MC**
- MH**
- ME**

- UC**

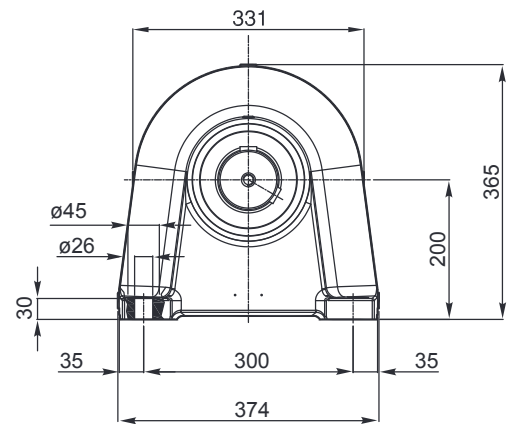
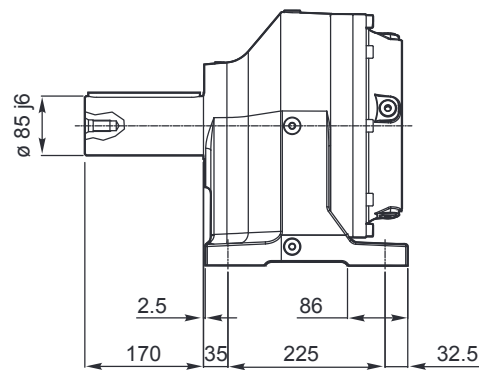
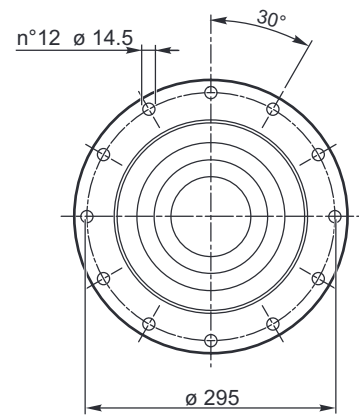
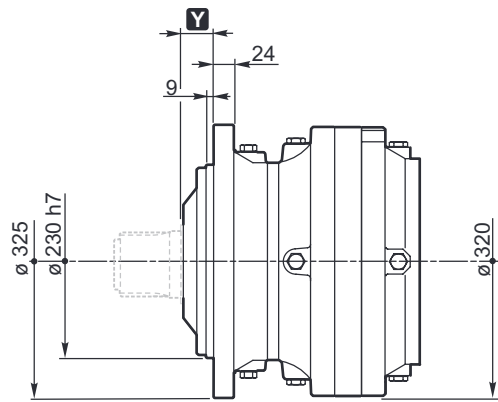

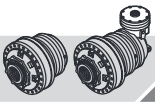

MS

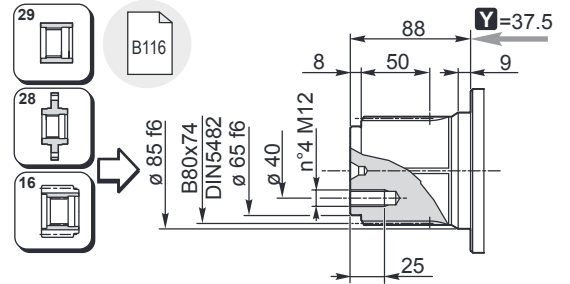
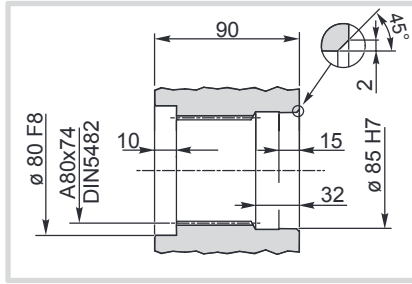
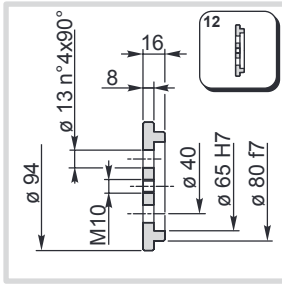

MC
UC

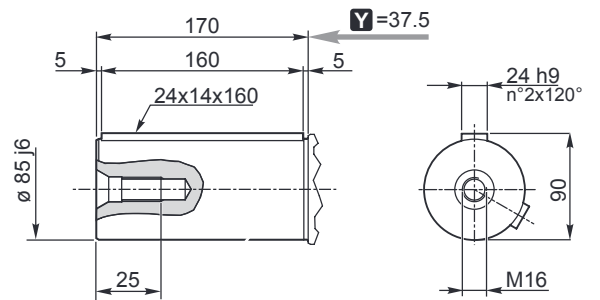
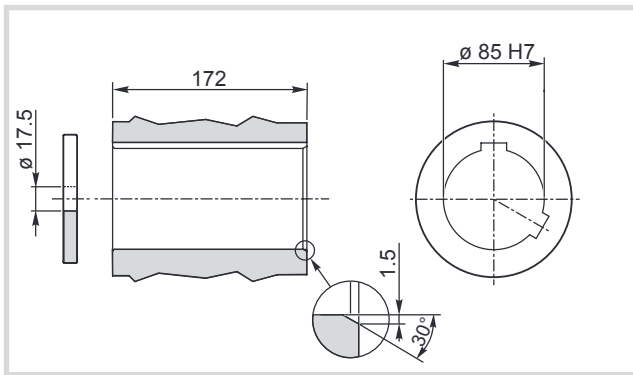

MH

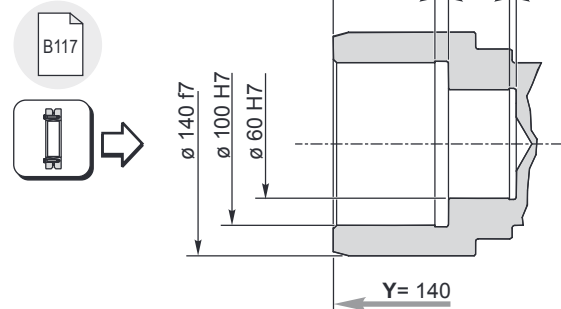
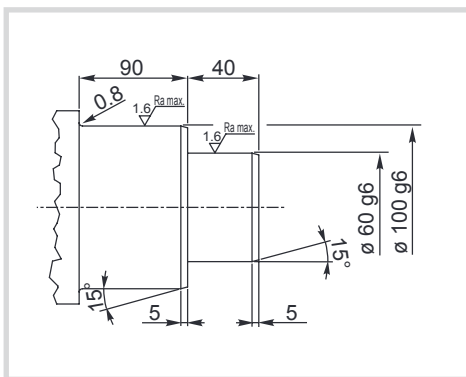

ME

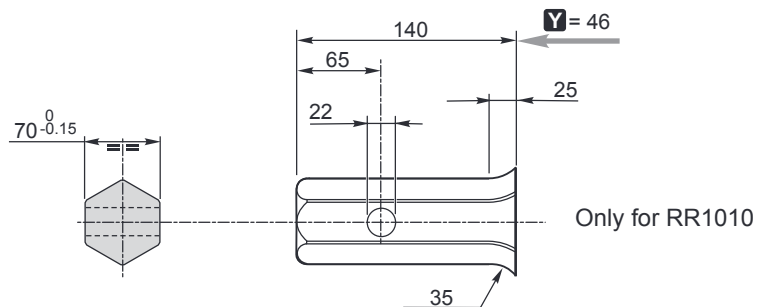

1010

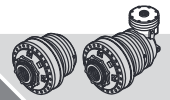

IT EN DE FR ES PT

RR1010
RA1010

FS

FS

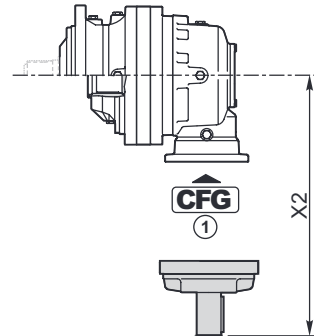
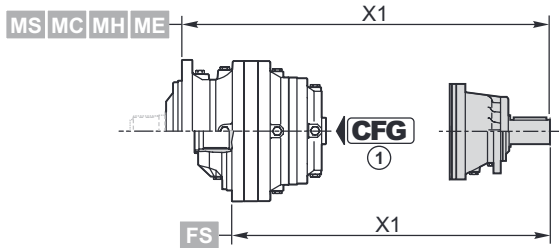
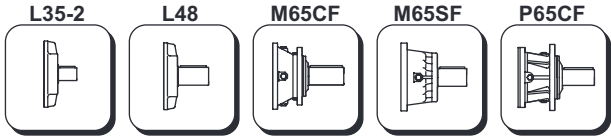
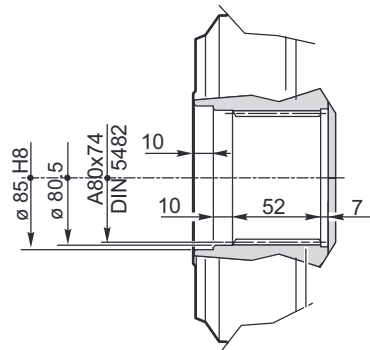
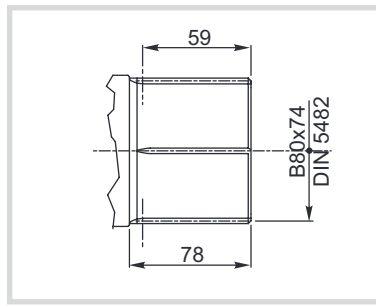
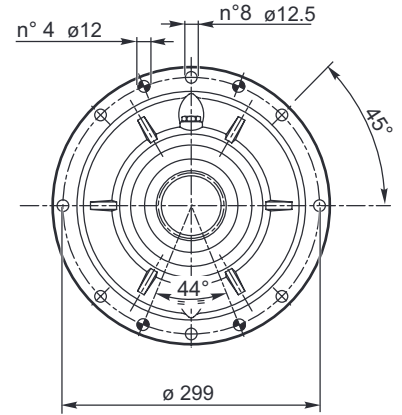
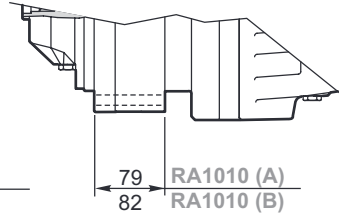
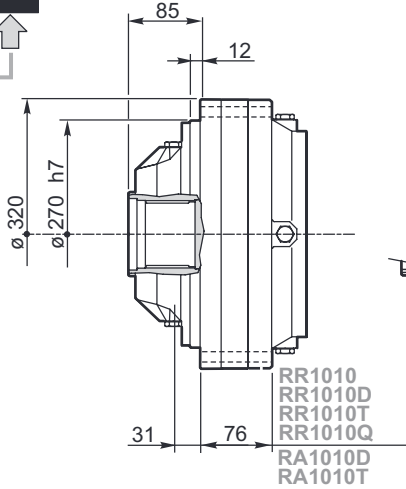

| | CFG ① | | code | X1 |
|---------|----------|-------|------------|----------------------------|
| RR1010 | — | P65CF | 154-2404 | 558 (M...) 439 (FS) |
| RR1010D | RF | M65SF | 154B4249 | 506.5 (M...) 387.5 (FS) |
| | RF | M65CF | 154-2407 | 529.5 (M...) 410.5 (FS) |
| | BOC | L48 | 154B3989 | 443.5 (M...) 324.5 (FS) |
| RR1010T | RF | M65SF | 154B4249 | 573 (M...) 454 (FS) |
| | RF | M65CF | 154-2407 | 596 (M...) 477 (FS) |
| | BOC | L48 | 154B3989 | 510 (M...) 391 (FS) |
| RR1010Q | BOC | L35-2 | 154-2190M1 | 544 (M...) 425 (FS) |

| | CFG ① | | code | X2 |
|------------|----------|-------|------------|-------|
| RA1010 (A) | BOC | L48 | 154B3989 | 347.5 |
| RA1010 (B) | - | P65CF | 154-2404 | 600 |
| RA1010D | BOC | L48 | 154B3989 | 347.5 |
| RA1010T | BOC | L35-2 | 154-2190M1 | 270.5 |

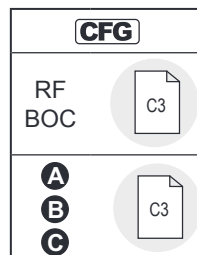



1010

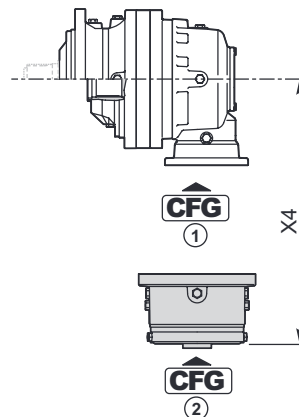
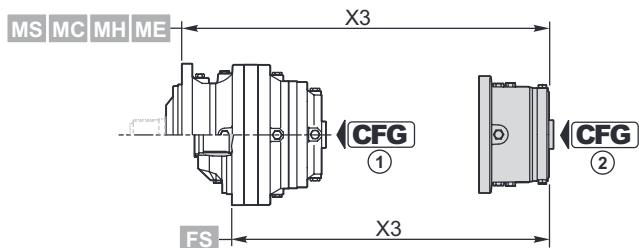
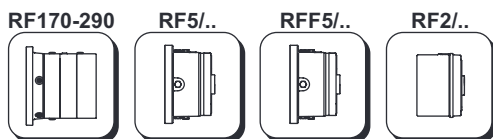

| RF170÷290 | CFG ① | T _f [Nm] | CFG ② | | |
|------------|-------|---------------------|------------|------------------------|-----|
| | | | G | | |
| | | | code | X3 | X4 |
| RR1010 | RF | 1700 | 154B9766M1 | 443 (M...) 324 (FS) | — |
| | | 2000 | 154B9767M1 | | |
| | | 2300 | 154B9768M1 | | |
| | | 2900 | 154B9769M1 | | |
| RA1010 (B) | - | 1700 | 154B9766M3 | — | 485 |
| | | 2000 | 154B9767M3 | | |
| | | 2300 | 154B9768M3 | | |
| | | 2900 | 154B9769M3 | | |

| RF5/.. | CFG ① | T _f [Nm] | CFG ② | | | | | | |
|---------|-------|---------------------|----------|----------------------------|----|-------------------|-------------------|----------------------------|----|
| | | | B | | | OMTS 12/24 z16 | OMVS 10/20 z16 | | |
| | | | code | X3 | X4 | code | code | X3 | X4 |
| RR1010D | RF | 210 | 154-2872 | 412.5 (M...) 293.5 (FS) | — | 154-2879 | 154-2886 | 416 (M...) 297 (FS) | — |
| | | 290 | 154-2873 | | | 154-2880 | 154-2887 | | |
| | | 430 | 154-2874 | | | 154-2881 | 154-2888 | | |
| | | 650 | 154-2875 | | | 154-2882 | 154-2889 | | |
| | | 850 | 154-2876 | | | 154-2883 | 154-2890 | | |
| | | 1100 | 154-2877 | | | 154-2884 | 154-2891 | | |
| | | 1300 | 154-2878 | | | 154-2885 | 154-2892 | | |
| RR1010T | RF | 210 | 154-2872 | 479 (M...) 360 (FS) | — | 154-2879 | 154-2886 | 482.7 (M...) 363.7 (FS) | — |
| | | 290 | 154-2873 | | | 154-2880 | 154-2887 | | |
| | | 430 | 154-2874 | | | 154-2881 | 154-2888 | | |
| | | 650 | 154-2875 | | | 154-2882 | 154-2889 | | |
| | | 850 | 154-2876 | | | 154-2883 | 154-2890 | | |
| | | 1100 | 154-2877 | | | 154-2884 | 154-2891 | | |
| | | 1300 | 154-2878 | | | 154-2885 | 154-2892 | | |

| RFF5/.. | CFG ① | T _f [Nm] | CFG ② | | | | | | |
|------------|-------|---------------------|----------|----|-------|-------------------|-------------------|----|-------|
| | | | B | | | OMTS 12/24 z16 | OMVS 10/20 z16 | | |
| | | | code | X3 | X4 | code | code | X3 | X4 |
| RA1010 (A) | RF | 210 | 154-2893 | — | 316.6 | 154-5338 | 154-5345 | — | 320.5 |
| | | 290 | 154-2894 | | | 154-5339 | 154-5346 | | |
| | | 430 | 154-2895 | | | 154-5340 | 154-5347 | | |
| | | 650 | 154-2896 | | | 154-5341 | 154-5348 | | |
| | | 850 | 154-2897 | | | 154-5342 | 154-5349 | | |
| | | 1100 | 154-2898 | | | 154-5343 | 154-5350 | | |
| | | 1300 | 154-2899 | | | 154-5344 | 154-5351 | | |
| RA1010D | RF | 210 | 154-2893 | — | 316.6 | 154-5338 | 154-5345 | — | 320.5 |
| | | 290 | 154-2894 | | | 154-5339 | 154-5346 | | |
| | | 430 | 154-2895 | | | 154-5340 | 154-5347 | | |
| | | 650 | 154-2896 | | | 154-5341 | 154-5348 | | |
| | | 850 | 154-2897 | | | 154-5342 | 154-5349 | | |
| | | 1100 | 154-2898 | | | 154-5343 | 154-5350 | | |
| | | 1300 | 154-2899 | | | 154-5344 | 154-5351 | | |



| RF2/.. | CFG ① | T _f [Nm] | CFG ② | | | | | | |
|---------|-------|------------------------|------------|----------------------------|-----------------------------|------------------------------|-----------------------------|------------------------------|----------------------------|
| | | | B | | OMP/OMR SAE A 2B Ø 25 | OMP/OMR SAE A 2B 1" 6B | OMP/OMR SAE A 4B Ø 25 | OMP/OMR SAE A 4B 1" 6B | |
| | | | code | X3 | code | code | code | code | X3 |
| RR1010D | RF | 70 | 154B9195 | 385 (M...) 266 (FS) | 154B9195M10 | - | 154B9195M16 | 154B9195M17 | 375 (M...) 256 (FS) |
| | | 140 | 154B9196 | | 154B9196M10 | - | 154B9196M16 | 154B9196M17 | |
| | | 210 | 154B9197 | | 154B9197M10 | - | 154B9197M16 | 154B9197M17 | |
| | | 320 | 154B9198 | | 154B9198M10 | - | 154B9198M16 | 154B9198M17 | |
| | | 430 | 154B9199 | | 154B9199M10 | - | 154B9199M16 | 154B9199M17 | |
| | | 600 | 154B9200 | | 154B9200M10 | - | 154B9200M16 | 154B9200M17 | |
| RR1010T | RF | 70 | 154-2345 | 451.5 (M...) 332.5 (FS) | 154-2345M10 | 154-2345M11 | 154-2345M16 | 154-2345M17 | 441.5 (M...) 322.5 (FS) |
| | | 140 | 154-2346 | | 154-2346M10 | 154-2346M11 | 154-2346M16 | 154-2346M17 | |
| | | 210 | 154-2347 | | 154-2347M10 | 154-2347M11 | 154-2347M16 | 154-2347M17 | |
| | | 320 | 154-2348 | | 154-2348M10 | 154-2348M11 | 154-2348M16 | 154-2348M17 | |
| | | 430 | 154-2349 | | 154-2349M10 | 154-2349M11 | 154-2349M16 | 154-2349M17 | |
| | | 600 | 154B9186 | | 154B9186M10 | 154B9186M11 | 154B9186M16 | 154B9186M17 | |
| RR1010Q | RF | 70 | 154-2838M1 | 493 (M...) 374 (FS) | 154-2863 | 154-2863M11 | 154-2635 | 154-2635M11 | 483 (M...) 364 (FS) |
| | | 140 | 154-2839M1 | | 154-2864 | 154-2864M11 | 154-2636 | 154-2636M11 | |
| | | 210 | 154-2840M1 | | 154-2865 | 154-2865M11 | 154-2637 | 154-2637M11 | |
| | | 320 | 154-2841M1 | | 154-2866 | 154-2866M11 | 154-2638 | 154-2638M11 | |
| | | 430 | 154-2842M1 | | 154-2867 | 154-2867M11 | 154-2639 | 154-2639M11 | |
| | | 600 | 154B8962M1 | | 154B9665 | 154B9665M11 | 154B9666 | 154B9666M11 | |

| | CFG ① | T _f [Nm] | CFG ② | | | | | | |
|------------|-------|------------------------|-------------|-------|-----------------------------|------------------------------|-----------------------------|------------------------------|-------|
| | | | B | | OMP/OMR SAE A 2B Ø 25 | OMP/OMR SAE A 2B 1" 6B | OMP/OMR SAE A 4B Ø 25 | OMP/OMR SAE A 4B 1" 6B | |
| | | | code | X4 | code | code | code | code | X4 |
| RA1010 (A) | RF | 70 | 154F2991 | 285.3 | | | | | — |
| | | 140 | 154F1890 | | | | | | |
| | | 210 | 154F2961 | | | | | | |
| | | 320 | 154B3591 | | | | | | |
| | | 430 | 154B3592 | | | | | | |
| | | 600 | 154F2992 | | | | | | |
| RA1010D | RF | 70 | 154F2991 | 285.3 | | | | | — |
| | | 140 | 154F1890 | | | | | | |
| | | 210 | 154F2961 | | | | | | |
| | | 320 | 154B3591 | | | | | | |
| | | 430 | 154B3592 | | | | | | |
| | | 600 | 154F2992 | | | | | | |
| RA1010T | RF | 70 | 154-2838M12 | 223.8 | 154-2863M12 | 154-2863M13 | 154-2635M12 | | 213.8 |
| | | 140 | 154-2839M12 | | 154-2864M12 | 154-2864M13 | 154-2636M12 | | |
| | | 210 | 154-2840M12 | | 154-2865M12 | 154-2865M13 | 154-2637M12 | | |
| | | 320 | 154-2841M12 | | 154-2866M12 | 154-2866M13 | 154-2638M12 | | |
| | | 430 | 154-2842M12 | | 154-2867M12 | 154-2867M13 | 154-2639M12 | | |
| | | 600 | 154B8962M12 | | 154B9665M12 | 154B9665M13 | 154B9666M12 | | |

CFG

RF
BOC

A
B
C

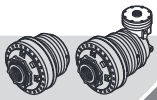

12

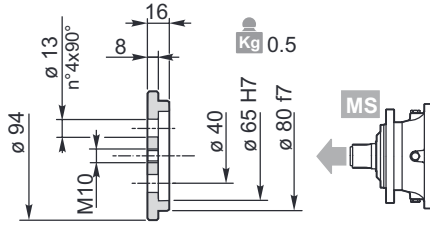

154-3062

Materiale / Material / Material / Matériau / Material / Material:
 Acciaio / Steel / Stahl / Acier / Acero / Aço
 C40 EN 10083-1 (1.1186)

28

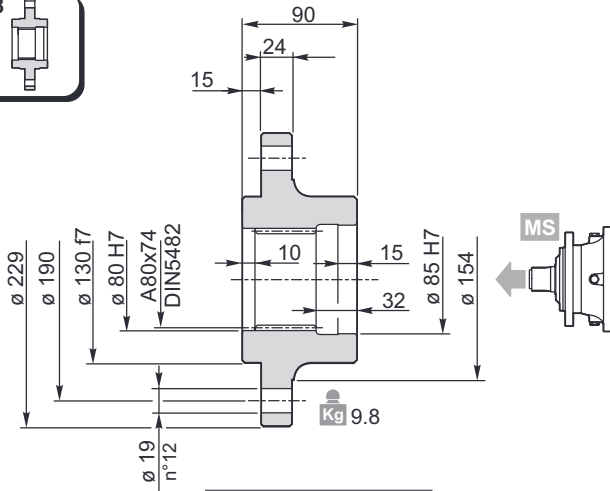

154-3359

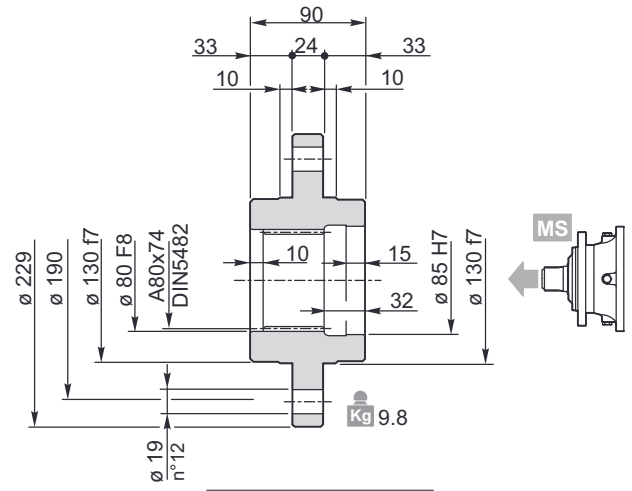

154-3112

Materiale / Material / Material / Matériau / Material / Material:
 Acciaio / Steel / Stahl / Acier / Acero / Aço EN 10083-1-C40 (1.1186)

29

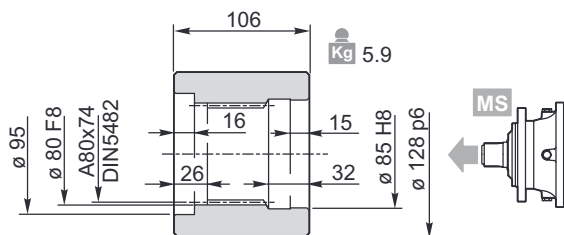

154-3093

Materiale / Material / Material / Matériau / Material / Material:
 Acciaio / Steel / Stahl / Acier / Acero / Aço 39NiCrMo3 UNI 7845 (1.6511)

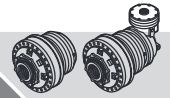

Materiale / Material / Material
 Matériau / Material / Material
 Acciaio / Steel / Stahl / Acier / Acero / Aço
 39NiCrMo3 UNI 7845 (1.6511)

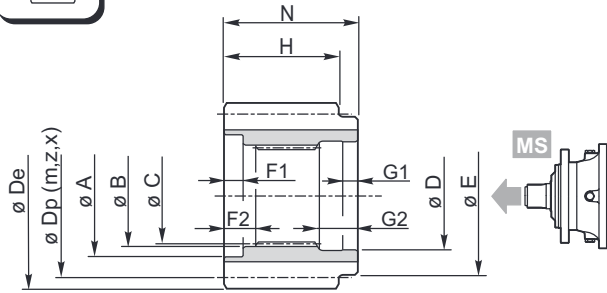

| | A | B | C | D | E | F1 | F2 | G1 | G2 | N | m | z | x | H | Dp | De | Code |
|----|----|-------|-------------------|-------|-----|----|----|----|----|-----|----|----|-------|----|-----|-------|-----------|
| MS | 96 | 80 F8 | DIN5482 A80x74 | 85 H8 | 124 | 15 | 25 | 12 | 30 | 105 | 8 | 17 | 0.5 | 90 | 136 | 159 | 154-3071 |
| | 96 | 80 F8 | DIN5482 A80x74 | 85 H8 | 124 | 15 | 25 | 12 | 30 | 105 | 10 | 12 | 0.425 | 90 | 120 | 146 | 154-3081 |
| | 96 | 80 F8 | DIN5482 A80x74 | 85 H8 | 105 | 15 | 25 | 12 | 30 | 105 | 10 | 12 | 0.5 | 90 | 120 | 148 | 154B3834 |
| | 96 | 80 F7 | DIN5482 A80x74 | 85 H7 | 124 | 15 | 25 | 12 | 30 | 105 | 10 | 15 | 0.5 | 90 | 150 | 180 | 154L02183 |
| | 96 | 80 F8 | DIN5482 A80x74 | 85 H8 | 124 | 15 | 25 | 12 | 30 | 105 | 10 | 18 | 0 | 90 | 180 | 198.5 | 154-3044 |
| | 96 | 80 F8 | DIN5482 A80x74 | 85 H8 | 130 | 15 | 25 | 12 | 30 | 105 | 12 | 14 | 0.25 | 90 | 168 | 194.5 | 154-3080 |



Kg 6.5

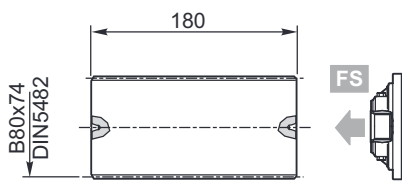

154-3054

Materiale / Material / Material
 Matériau / Material / Material:
 Acciaio / Steel / Stahl / Acier / Acero / Aço
 39NiCrMo3 UNI 7845 (1.6511)

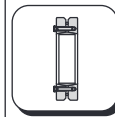

Kg 10

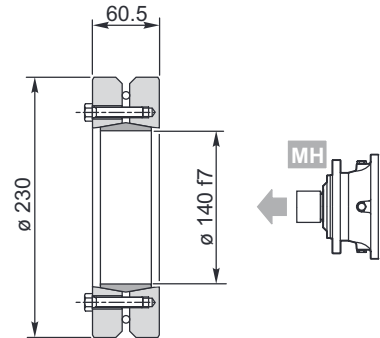

154F3778

C40

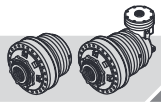

1010

IT EN DE FR ES PT

| | | | |
|----|------|----|-----------|
| RR | 1010 | .. | MS |
| RA | | | MC |
| | | | ME |

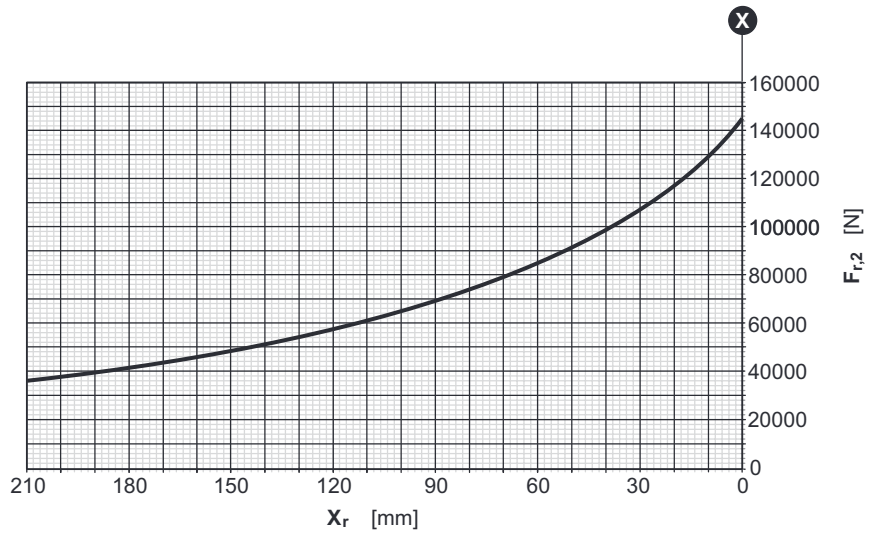
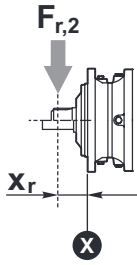

Fattore correttivo k_{r2} / k_{r2} Corrective coefficient / Korrekturfaktor k_{r2}
 Facteur correctif k_{r2} / Factor de corrección k_{r2} / Fator corretivo k_{r2}

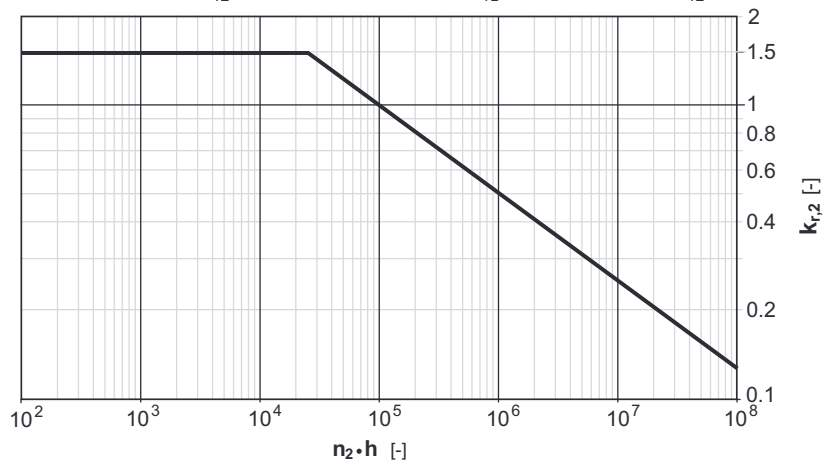

| | | | |
|----|------|----|----|
| RR | 1010 | .. | UC |
| RA | | | |

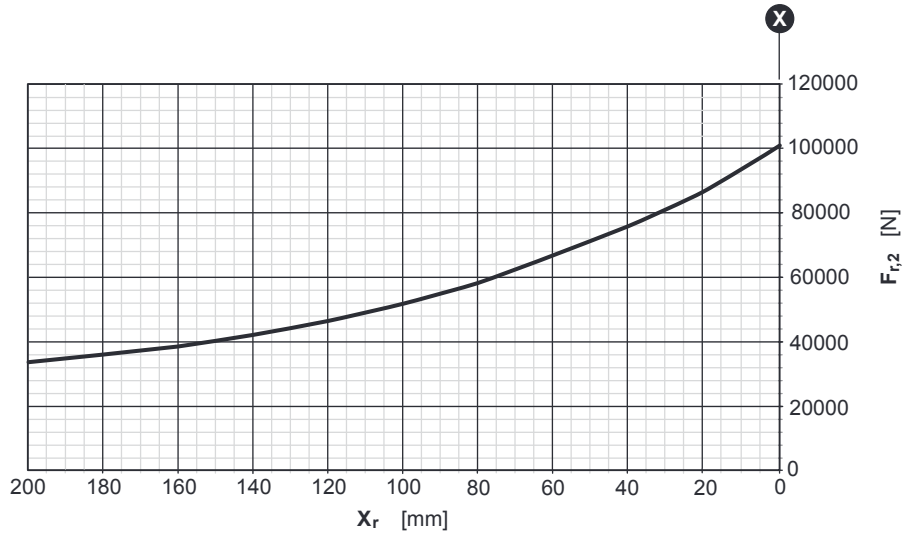
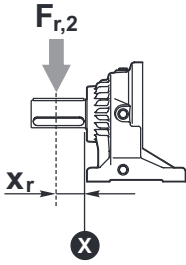

Fattore correttivo k_{r2} / k_{r2} Corrective coefficient / Korrekturfaktor k_{r2}
 Facteur correctif k_{r2} / Factor de corrección k_{r2} / Fator corretivo k_{r2}

